



Britax

Roundabout® 50 *Classic*

User Guide





Safety Information

Warnings.....	2
Important Notes.....	4
Certification.....	5
Registration.....	5
Important Harness Adjustments.....	6

Child Seat Features.....8

Vehicle Compatibility

Compatible Vehicle Seat Belts.....	10
Incompatible Vehicle Seat Belts.....	14
Vehicle Buckle Positions.....	15
Vehicle Seating Positions.....	15

Installation: Rear-Facing

LATCH Installation.....	16
Lap-Shoulder Belt Installation.....	18
Lap-Belt Installation.....	20

Installation: Forward-Facing

LATCH Installation.....	22
Lap-Shoulder Belt Installation.....	24
Lap-Belt Installation.....	26

Installation: Aircraft.....28

Installation: Versa-Tether®

Safety Information.....	29
Using the Versa-Tether.....	30
Tether Connector Strap.....	31
Energy-Absorbing Versa-Tether.....	32

Child Seat Functions

Switching the LATCH Mode.....	33
Storing the LATCH Connectors.....	34
Recline Adjustment.....	34
Using the Locking Clip.....	35
Chest Clip.....	36
Harness Buckle.....	36
Adjusting Harness Slot Height.....	37
Adjusting Harness Buckle Position.....	38

Securing Your Child.....39

Care and Maintenance.....41

Warranty.....44



WARNING!

DEATH or SERIOUS INJURY can occur:

- Use only in a rear-facing position when using it with an infant weighing less than 20 lbs (9.1 kg) **OR** is less than 1 year of age.
- Use only with children who weigh between 5 and 50 lbs (2.3 and 22.7 kg) and whose height is 49 inches (124.5 cm) or less. Rear-facing for children who weigh between 5 and 35 lbs (2.3 and 15.9 kg) and forward-facing for children who weigh between 20 and 50 lbs (9.1 - 22.7 kg) and are at least 1 year of age.
- Snugly adjust the belts provided with this child restraint around your child. A snug strap should not allow any slack. It lies in a relatively straight line without sagging. It does not press into the child's flesh or push the child's body into an unnatural position.
- Secure the top anchorage strap provided with this child restraint.
- Secure this child restraint with the vehicle's child restraint anchorage system if available or with a vehicle belt.
- Follow all instructions on this child restraint and in the written instructions located under the child seat cover.
- Register your child restraint with the manufacturer.
- To prevent injury due to deterioration or hidden damage, discontinue use of a child seat that is older than six (6) years or has been in a moderate or severe crash. See *Serial Number and Manufactured Date Label* located on child seat (see page 8).
- This child seat must not be used in the home, in boats, or other non-certified applications.

- Based on crash statistics, the National Highway Traffic Safety Administration (NHTSA) recommends that parents select the back seat as the safest location for a properly installed child seat. Please study the Vehicle Compatibility (pages 10-15) section in this booklet to ensure your child's safety and consult your vehicle owner's manual.
- Secure this child seat even when it is not occupied. In a crash, an unsecured child seat may injure vehicle occupants.
- When using in a vehicle with air bags, refer to your vehicle owner's manual for child seat installation instructions and precautions.
- Never use adjuster strap to lift or carry this child seat. Doing so could cause damage to harness adjuster and webbing. Always carry this child seat by its shell or tether straps.
- The primary protection for occupants of a vehicle in a collision is the body of the vehicle itself. A child seat will not protect a child when a vehicle is seriously impacted. However, correctly installed, a child seat will substantially improve chances for survival in most crashes. Make sure all users fully understand the correct ways to use this child seat in a vehicle.
- The use of non-Britax Child Safety, Inc. covers, inserts, toys, accessories, or tightening devices is not approved by Britax. Their use could cause this child seat to fail Federal Safety Standards or not perform as intended in a crash.



Important Notes

- Verify child seat is secure and harness is properly adjusted around child each time child seat is used.
- Adjust harness to fit clothes the child is wearing. Remove bulky coats and/or jackets before putting child in child seat.
- Cover child seat when vehicle is parked in direct sunlight. Parts of child seat could become hot enough to burn a child.
- Store child seat in a safe place when it is not being used. Avoid placing heavy objects on top of it.
- Do not leave children alone in a vehicle, even for a short time.
- Do not, except as described in this booklet, attempt to disassemble any part of the child seat or change the way its harness or vehicle's seat belts are used.
- Do not leave loose objects, e.g. books, bags, etc., in the back of a vehicle. In the event of a sudden stop, loose objects will keep moving, potentially causing serious injuries.
- Do not leave folding vehicle seats unsecured or unlatched. In event of a sudden stop, a loose seat back could prevent child seat from protecting the child as well as it should.
- Do not allow children to play with this or any child seat.
- Do not use anything to raise child seat off vehicle seat except as described in these instructions. In a crash, child seat could slide and may not adequately protect the child.



WARNING! DO NOT place a child seat rear-facing in the front seat of a vehicle with a passenger air bag. DEATH or SERIOUS INJURY can occur. See your vehicle owner's manual for child seat installations. The back seat is the safest place for children 12 and under.

Certification

This child seat system conforms to all applicable Federal Motor Vehicle Safety Standards. **This Child Restraint is Certified for Use in Motor Vehicles and Aircraft.**

Registration

Child seats can be recalled for safety reasons. You must register this child seat to be reached in a recall. Send your name, address, and the child seat's model number and manufacturing date to Britax Child Safety, Inc., 13501 South Ridge Drive, Charlotte, NC 28273, or call 1-888-4BRITAX, or register online at www.BritaxUSA.com/registration. For recall information, call the US Government's Vehicle Safety Hotline at 1-888-327-4236 (TTY 1-800-424-9153), or go to <http://www.NHTSA.gov>.

Serial Number: _____

Batch Number: _____

Date of Manufacture: _____



Important Harness Adjustments

According to the American Academy of Pediatrics:

All infants should ride rear-facing until they have reached at least 1 year of age **and** weigh at least 20 pounds (9.1 kg). That means that if your infant reaches 20 pounds (9.1 kg) before her first birthday, she should remain rear-facing at least until she turns 1 year old. It is best for children to ride rear-facing to the highest weight or height allowed by the manufacturer.

Rear-Facing

Use rear-facing only with children:

- *who weigh between 5 and 35 lbs (2.3 – 15.9 kg) and*
- *the top of the child's head is at least 1" (2.5 cm) or more below the top of the child seat (Fig. A) and*
- *the harness straps are in the nearest slots at or below the child's shoulders.*

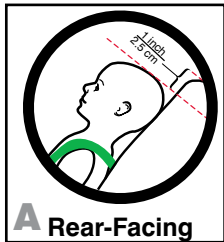

If the child cannot be secured within these requirements because the child exceeds height or weight requirements, review the Forward-Facing guidelines on page 7.

If the child cannot be secured within these requirements because the child is too small, selection of a different child seat (such as an infant carrier) may be required.

IMPORTANT: See Adjusting Harness Slot Height on page 37.



WARNING!

Do **NOT** use the child seat rear-facing if any of the following apply:

- *the child is less than 5 lbs (2.3 kg) in weight or*
- *the child exceeds 35 lbs (15.9 kg) in weight or*
- *the top of the head is less than 1" (2.5 cm) from the top of the child seat (Fig. A) or*
- *the harness straps are in a slot above the child's shoulders.*

Forward-Facing

Use forward-facing only with children:

- *who are at least one year of age and*
- *who weigh between 20 and 50 lbs (9.1 – 22.7 kg) and*
- *49" (124.5 cm) or less in height and*
- *the top of the child's ears are below the top of the child seat and*
- *the harness straps are in the nearest slots at or above the child's shoulders, parallel to level ground (Fig. B).*

IMPORTANT: When using forward-facing recline mode, it may become necessary to adjust the harness to the next higher set of slots than would be used when the seat is upright. See Adjusting Harness Slot Height on page 37.

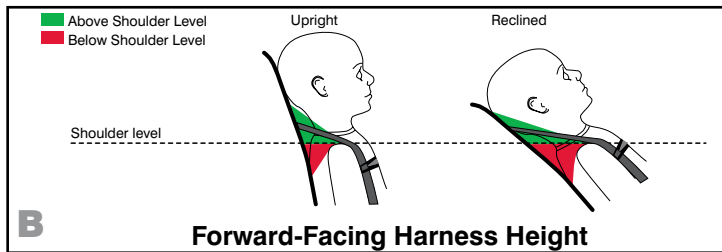

WARNING!

Do **NOT** use the child seat forward-facing if any of the following apply:

- *the child is less than one year of age or*
- *the child is less than 20 lbs (9.1 kg) in weight or*
- *the child exceeds 50 lbs (22.7 kg) in weight or*
- *the child exceeds 49" (124.5 cm) in height or*
- *the top of the ears are above the top of the child seat or*
- *the top harness slots fall below the child's shoulders, parallel to level ground (Fig. B)*



- | | |
|---|---|
| 1 Cover | 8 LATCH Connector |
| 2 Serial Number and Manufactured Date Label (Under Cover) | 9 Harness Holder |
| 3 Chest Clip | 10 Harness Straps |
| 4 Rear-Facing Belt Path | 11 Harness Buckle |
| 5 LATCH Adjuster Release Button | 12 Belly Pad |
| 6 LATCH Adjuster | 13 Harness-Adjuster Release Lever (Under Cover) |
| 7 LATCH Connector Release Button | 14 Harness Adjuster Strap |
| | 15 Recline Handle |



16 Versa-Tether® (Top Anchorage Strap) - in pouch

17 Locking Clip (behind pouch)

18 Shell

19 Harness Yoke

20 Belt Guard

21 Energy-Absorbing Base

22 Forward-Facing Belt Path



IMPORTANT: When not in use, this user guide should be stored under the cover. **DO NOT discard the foam inserts found under the cover.**



Compatible Vehicle Seat Belts

NOTE: *The information in this section only applies to installation with vehicle safety belts.*

Vehicle seats and safety belts differ from vehicle to vehicle. Refer to your vehicle owner's manual for specific information about your vehicle safety belts and their use with child seats.

Lap-Shoulder (3-Point) Belt

1. ALR (Automatic Locking Retractor) with Sliding Latch Plate

- a** *Has a latch plate that freely slides along the vehicle belt webbing.*

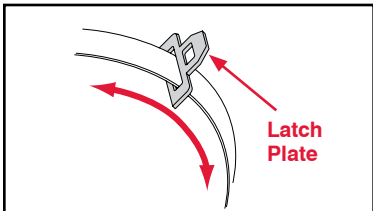

- b** *Has a retractor that stops the belt from being pulled out again once the belt webbing has been pulled out at least 24 in. (61 cm).*

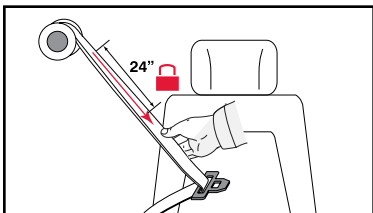

- c** *Tightens by feeding the belt webbing back into the retractor.*

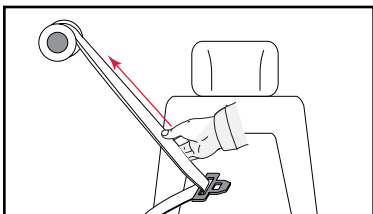

2. ELR (Emergency Locking Retractor) with Locking Latch Plate

a Has a latch plate that does not allow the lap part of the belt to become loose after it is buckled.

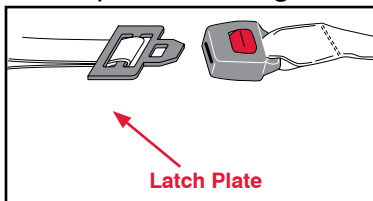

b Has a retractor that locks only in an emergency situation such as sudden stop or crash.

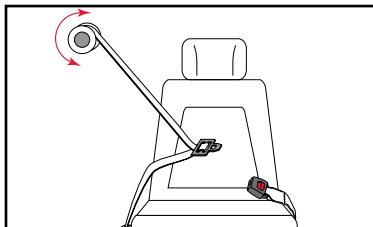

3. Switchable Retractor in ALR with Sliding Latch Plate

a Has a latch plate that freely slides along the vehicle belt webbing.

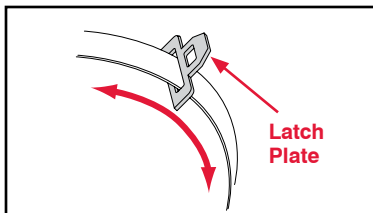

b Has a retractor that can be switched to function as an ALR by pulling the vehicle belt fully out until a clicking sound can be heard when retracting.

* To use a child seat with this type of vehicle belt, you will need to switch to the ALR mode or use child seat lock-offs.

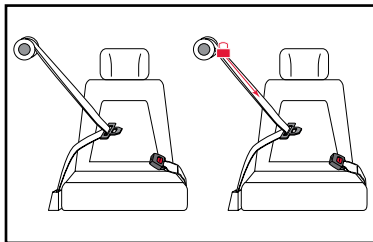

4. ELR (Emergency Locking Retractor) with a Sliding Latch Plate

- a Has a latch plate that freely slides along the vehicle belt webbing.
- b Has a retractor that locks only in an emergency situation such as sudden stop or crash.

IMPORTANT: This belt type requires the use of the lock-offs built into the seat for rear- and forward-facing installations.

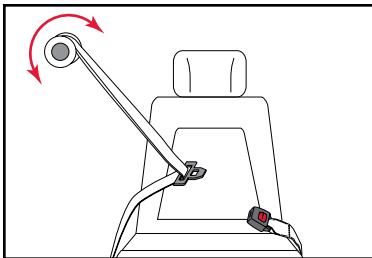

Lap Belt

5. ALR (Automatic Locking Retractor)

- a Has a latch plate that is sewn into the webbing.

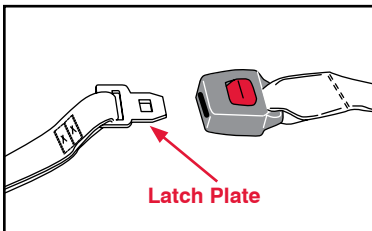

- b Has a retractor that stops the belt from being pulled out again once the belt webbing has been pulled out at least 24 in. (61 cm).

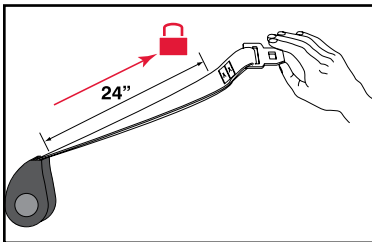

- c** Tightens by feeding the belt webbing back into the retractor.

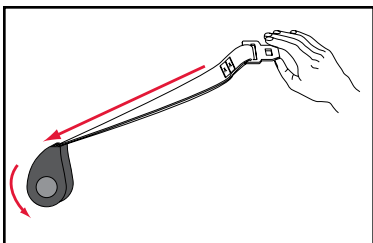

6. Locking Latch Plate

- a** Has a latch plate that does not allow the belt to become loose after it is buckled.

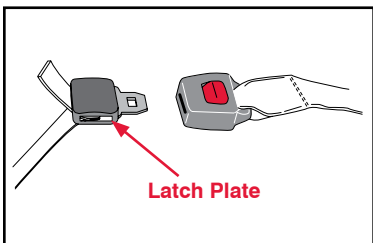

- b** Tightens by pulling on the belt webbing.

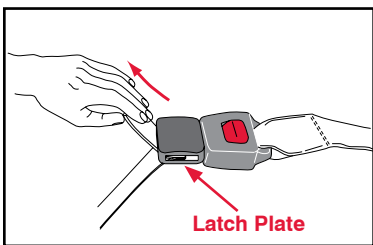

Incompatible Vehicle Belts

⚠ WARNING! The following types of vehicle belts are NOT compatible with this child seat:



1 Vehicle belts with top or bottom anchor points on the vehicle door.

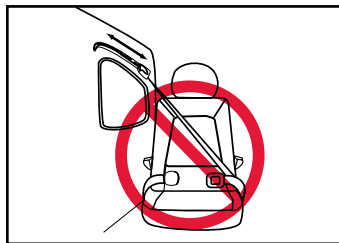

2 Motorized, automatic vehicle belts

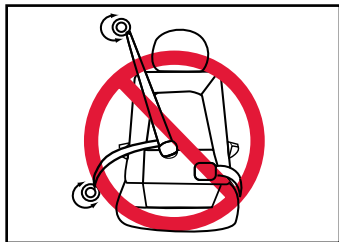

3 Lap-shoulder belts that have a separate retractor each for the lap section and shoulder section



4 Lap belts forward of the vehicle seat backrest.

5 Lap belts that have a retractor that locks only in case of a sudden stop (emergency locking retractor or ELR).



Vehicle Buckle Positions

⚠ WARNING! The position of the vehicle belt buckle can adversely affect the stability of the child seat.

If the buckle lies near the incorrect position (X) when the vehicle belt is tightened, try fitting the child seat in another seating position in the vehicle OR consult your vehicle owner's manual to see if you can lower the vehicle buckle position by twisting the vehicle buckle stalk. If it is not possible to achieve the correct position (✓) for the buckle, then another seating position MUST be used.

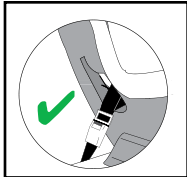
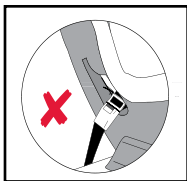

Vehicle Seating Positions

⚠ WARNING! Some vehicles have no seating positions which are compatible with this child seat or any other child seat. If in doubt, contact the vehicle manufacturer for assistance.

Forward-facing vehicle seats MUST be used with this child seat. Side-facing or rear-facing seats CANNOT be used. See diagram below.

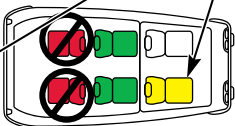
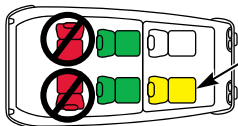

⚠ WARNING! DO NOT place a child seat rear-facing in the front seat of a vehicle with a passenger air bag unless deactivated. DEATH or SERIOUS INJURY can occur. See your vehicle owner's manual for child seat installation instructions. The back seat is the safest place for children 12 and under.

LATCH Installation

- Figure A illustrates a rear-facing LATCH installation.
 - Verify that your vehicle is equipped with LATCH anchors. If LATCH anchors are not available, you must use the vehicle belt installation methods.
- 1 If stored, remove the LATCH connectors from the storage slots under the cover (page 34) and pass them through their adjacent belt slots.

IMPORTANT:

- This child seat is shipped with the buckle in position 1 (Fig. B). Use buckle position 1 or 2 that is closest to but **not underneath** your child. Do not use buckle position 3 in rear-facing mode. See page 38 for *Adjusting Harness Buckle Position*.
 - The LATCH strap must rest **IN FRONT OF** the child seat buckle when using buckle slots 1 or 2 (Fig. B).
- 2 Press and hold the LATCH adjuster release button, then pull the LATCH strap to full length.
 - 3 Recline the child seat and place rear-facing on the vehicle seat. This child seat **must** be in the recline position when installed rear-facing. See *Recline Adjustment* on page 34.
 - 4 Attach one LATCH connector to its adjacent vehicle LATCH anchor (Fig. C) in the upright position (Fig. D).
 - An audible click confirms attachment.
 - Ensure that the LATCH strap is not twisted.

TIP: You may need to turn the front of the child seat toward you for easier access to the vehicle LATCH anchor.

- 5 Attach the remaining LATCH connector to its adjacent vehicle LATCH anchor (Fig. E) in the upright position (Fig. D).
 - An audible click confirms attachment.
 - Ensure that the LATCH strap is not twisted.

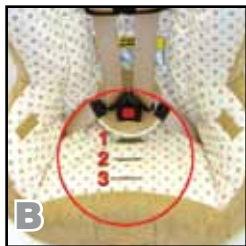
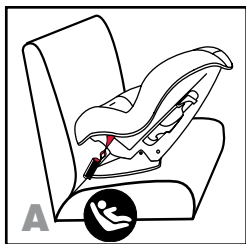

NOTE: If an audible click is not heard when connecting either LATCH connector, the LATCH strap may be twisted, or there may be debris in the LATCH connector. Correct either situation before continuing with the installation process.

6 Push the child seat firmly into the vehicle seat while pulling the LATCH strap tight (Fig. F).

IMPORTANT: Ensure the LATCH strap does not fold into the LATCH adjuster while tightening.

7 Verify that all connections are secure and that the child seat is stable.

- The child seat is secure when it cannot be moved more than 1 in. (2.5 cm) front-to-back or side-to-side at the belt path. If the child seat is not secure, repeat the installation process or use an alternate seating location.
- When properly installed in the rear-facing position, the back angle of the child seat should be 30° – 45° from vertical (not to exceed 45°) when the car is parked on a level surface (Fig. G).
- If necessary, the proper recline angle can be achieved by placing a rolled towel or pool noodle in the vehicle seat bight to level the child seat's base.

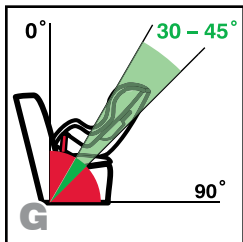

WARNING! Do not raise the child seat off the front edge of the vehicle seat. This could cause your child seat not to perform as intended.

- Rear-facing installation can be improved by the use of the Versa-Tether. See pages 29 – 32.

Lap-Shoulder Belt Installation

- Figure A illustrates a typical rear-facing, lap-shoulder belt installation.
- When not in use, always store the LATCH connectors in the storage slots. See page 34.
- See vehicle owner's manual to determine what type of seat belt system your vehicle has, and how to lock it (also see pg 10-13).

IMPORTANT: This child seat is shipped with the buckle in position 1 (Fig. B). Use buckle position 1 or 2 that is closest to but *not underneath* your child. Do not use buckle position 3 in rear-facing mode. See page 38 for Adjusting Harness Buckle Position.

- 1 Recline the child seat then place it rear-facing on the vehicle seat. This child seat **must** be in the recline position when installed rear-facing. See Recline Adjustment on page 34.
- 2 Pull the vehicle belt out then pass it through the first rear-facing belt slot (Fig. C).
- 3 Route the vehicle belt across the child seat and then through the second rear-facing belt slot.

IMPORTANT:

- The vehicle belt must rest **IN FRONT OF** the child seat buckle when using buckle slots 1 or 2 (Fig. B).
 - Vehicle belt can be routed over or under the cover.
- 4 Verify that the vehicle belt is not twisted and then buckle (Fig. D).
 - 5 Push the child seat firmly into the vehicle seat while removing slack first from the lap portion of the vehicle belt, then the shoulder portion (Fig. E).

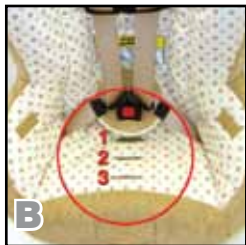
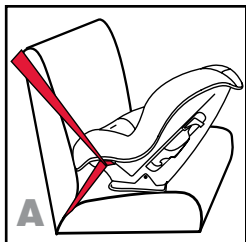

- Ensure the vehicle seat belt system is locked.
 - If your vehicle is not equipped with a lockable seat belt system, use of a locking clip may be required. See page 35 for locking clip instructions
- 6 Verify that the vehicle belt is tight, locked and that the child seat is secure.
- The child seat is secure when it cannot be moved more than 1 in. (2.5 cm) front-to-back or side-to-side at the belt path.
 - When properly installed in the rear-facing position, the back angle of the child seat should be 30° – 45° from vertical (not to exceed 45°) when the car is parked on a level surface (Fig. F).
 - If necessary, the proper recline angle can be achieved by placing a rolled towel or pool noodle in the vehicle seat bight to level the child seat's base.

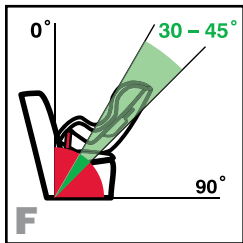

WARNING! Do not raise the child seat off the front edge of the vehicle seat. This could cause your child seat not to perform as intended.

- Rear-facing installation can be improved by using the Versa-Tether. See pages 29 - 32.

Lap-Belt Installation

- *Figure A illustrates a typical rear-facing, lap-belt installation.*
- *When not in use, always store the LATCH connectors in storage slots. See page 34.*
- *See vehicle owner's manual to determine what type of retractor your vehicle has and how to lock it (also see pg 10-13).*

IMPORTANT: *This child seat is shipped with the buckle in position 1 (Fig. B). Use buckle position 1 or 2 that is closest to but not underneath your child. Do not use buckle position 3 in rear-facing mode. See page 38 for Adjusting Harness Buckle Position.*

- 1 Recline the child seat and then place it rear-facing on vehicle seat. This child seat **must** be in the recline position when installed rear-facing. See Recline Adjustment on page 34.
- 2 Pull the vehicle belt out and pass it through the closest rear-facing belt slot (Fig. C).
- 3 Route the vehicle belt across the child seat then through the second rear-facing belt slot.

IMPORTANT:

- *The vehicle belt must rest **IN FRONT OF** the child seat buckle when using buckle slots 1 or 2 (Fig. B).*
- *Vehicle belt can be routed over or under the cover.*

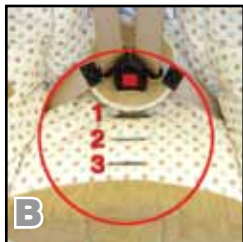
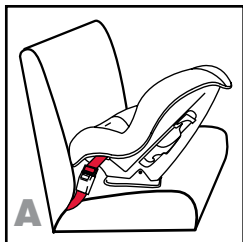

- 4 Verify that the vehicle belt is not twisted and then buckle (Fig. D).
- 5 Push the child seat firmly into the vehicle seat while removing slack from the vehicle belt.
 - *Ensure the vehicle seat belt system is locked.*



⚠ WARNING! Do not use this seat with a two-point Emergency Locking Retractor (ELR) vehicle belt that does not lock.

- 6 Verify that the vehicle belt is tight, locked, and that the child seat is secure.
 - *The child seat is secure when it cannot be moved more than one inch (2.5 cm) front-to-back or side-to-side at the belt path.*
 - *When properly installed in the rear-facing position, the back angle of the child seat should be 30° – 45° from vertical (not to exceed 45°) when the car is parked on a level surface (Fig. F).*
 - *If necessary, the proper recline angle can be achieved by placing a rolled towel or pool noodle in the crease of the vehicle seat to level the child seat's base.*

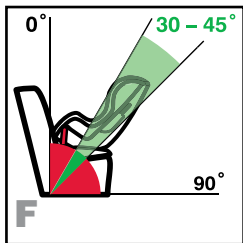

⚠ WARNING! Do not raise the child seat off the front edge of the vehicle seat. This could cause your child seat not to perform as intended.

- *Rear-facing installation can be improved by the use of the Versa-Tether. See pages 29 - 32.*

LATCH Installation

- Figure A illustrates a forward-facing LATCH installation.
- Verify that your vehicle is equipped with LATCH anchors. If LATCH anchors are not available, you must use vehicle belt installation methods.



WARNING!

- This child seat must not be used forward-facing for children less than one year of age OR who weigh less than 20 lbs (9.1 kg).
- This child seat must be in full upright position when installed forward-facing for children who weigh more than 33 pounds (15.1 kg).

IMPORTANT: This child seat is shipped with the buckle in position 1 (Fig. B). Use buckle position 1, 2 or 3 that is closest to but not underneath your child. See page 38 for Adjusting Harness Buckle Position.

- 1 If stored, remove the LATCH connectors from the storage slots under the cover (page 34) and pull both connectors completely through the child seat's right side (Fig. C).
- 2 Press and hold the LATCH adjuster release button, then pull the LATCH strap to full length.
- 3 Thread one LATCH connector through the forward-facing belt path to the opposite side of the child seat. Ensure that the LATCH strap is not twisted.
- 4 Remove the Versa-Tether from the pouch and place it up and over the child seat back.
- 5 Place the child seat forward-facing on the vehicle seat.

TIP: You may need to raise or remove the vehicle head restraint to achieve best fit of the child seat.

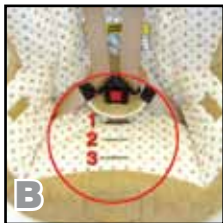
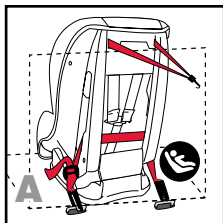

- 6 Attach one LATCH connector to its adjacent vehicle LATCH anchor (Fig. D) in the upright position (Fig. E).

- An audible click confirms attachment.
- Ensure that the LATCH strap is not twisted.

TIP: You may need to turn the back of the child seat toward you for easier access to the vehicle LATCH anchor.

- 7 Attach the remaining LATCH connector to its adjacent vehicle LATCH anchor (Fig. F) in an upright position (Fig. E).

- An audible click confirms attachment.
- Ensure that the LATCH strap is not twisted.

NOTE: If an audible click is not heard when connecting either LATCH connector, the LATCH strap may be twisted, or there may be debris in the LATCH connector. Correct either situation before continuing with the installation process.

- 8 Push the child seat into the vehicle seat while pulling the LATCH strap tight (Fig. G).

IMPORTANT: Ensure the LATCH strap does not fold into the LATCH adjuster while tightening.

- 9 Attach the Versa Tether[®] hook to the vehicle's designated tether anchor for the chosen seating position. Remove all slack from the tether to secure. Store excess webbing in the tether pouch. See pages 29 – 32.

- 10 Verify that all connections are secure and that the child seat is stable.
- The child seat is secure when it cannot be moved front-to-back or side-to-side more than 1 in. (2.5 cm) at the belt path. If the child seat is not secure, repeat the installation process or use an alternate seating location.



WARNING! Refer to your vehicle owner's manual or contact the vehicle manufacturer for the maximum weight rating for their LATCH anchors. Use vehicle belt (not LATCH connectors) for installations with children who weigh more than the vehicle LATCH anchor limit. Unless specified otherwise by the vehicle manufacturer, assume a 40 lbs (18.1 kg) child is the vehicle LATCH anchor limit.

Lap-Shoulder Belt Installation

- Figure A illustrates a typical forward-facing lap-shoulder belt installation.
- When not in use, always store LATCH connectors in storage slots. See page 34.
- See vehicle owner's manual to determine what type of seat belt system your vehicle has, and how to lock it.

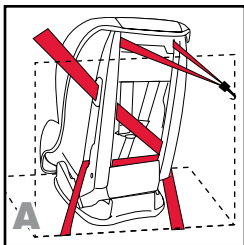

WARNING!

- This child seat must not be used forward-facing for children less than one year of age OR who weigh less than 20 lbs (9.1 kg).
- Child seat must be in the full upright position when installed in forward-facing mode with children over 33 lbs (15.1 kg).

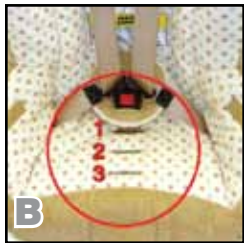

IMPORTANT:

- The child seat is shipped with the buckle in position 1 (Fig. B). Use buckle position 1, 2 or 3 that is closest to but not underneath your child. See page 38 for Adjusting Harness Buckle Position.
 - Britax recommends that the Versa-Tether be used at all times. Using the tether will improve the stability of the child seat and reduce the risk of injury. Check your vehicle owner's manual for approved tether anchor locations.
- 1 If the vehicle is equipped with an approved tether anchor for the chosen seating position, remove the Versa-Tether® from the pouch and place it up and over the child seat back.
 - 2 Place the child seat forward-facing on the vehicle seat.

TIP: You may need to raise or remove the vehicle head restraint to achieve best fit of the child seat.

- 3 Pull the vehicle belt out and thread it through the forward-facing belt path (Fig. C).

TIP: Turning the back of the child seat toward you can make routing the vehicle belt easier.

- 4 Verify that the vehicle belt is not twisted and buckle (Fig. D).

- 5 Push the child seat firmly into the vehicle seat while removing slack first from the lap portion of the vehicle belt, then the shoulder portion (Fig. E).



- Ensure the vehicle seat belt system is locked.
- If your vehicle is not equipped with a lockable seat belt system, use of a locking clip may be required. See page 35 for locking clip instructions.

- 6 If the vehicle is equipped with an approved tether anchor, attach the Versa-Tether[®] hook to an approved tether anchor. Remove all slack from the tether to secure. Store excess webbing in the tether pouch. See pages 29 - 32.

- 7 Verify that the vehicle belt is tight, locked, and that the child seat is secure.



- The child seat is secure when it cannot be moved front-to-back or side-to-side more than 1 inch (2.5 cm.) at the belt path. If the child seat is not secure, repeat the installation process or use an alternate seating location.

Lap-Belt Installation

- Figure A illustrates a typical forward-facing, lap-belt installation.
- When not in use, always store the LATCH connectors in storage slots. See page 34.

WARNING!

- This child seat must not be used forward-facing for children less than one year of age OR who weigh less than 20 lbs (9.1 kg).
- Child seat must be in the full upright position when installed in forward-facing mode with children over 33 lbs (15.1 kg).

IMPORTANT:

- The child seat is shipped with the buckle in position 1 (Fig. B). Use buckle position 1, 2 or 3 that is closest to but not underneath your child. See page 38 for Adjusting Harness Buckle Position.
 - Britax recommends that the Versa-Tether be used at all times. Using the tether will improve the stability of the child seat and reduce the risk of injury. Check your vehicle owner's manual for approved tether anchor locations.
- 1 If the vehicle is equipped with an approved tether anchor for the chosen seating position, remove the Versa-Tether® from the pouch and place it up and over the child seat back.
 - 2 Place the child seat forward-facing on the vehicle seat
- TIP:** You may need to raise or remove the vehicle head restraint to achieve best fit of the child seat.

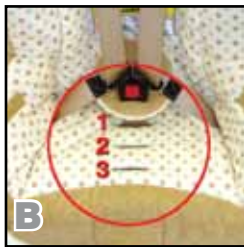
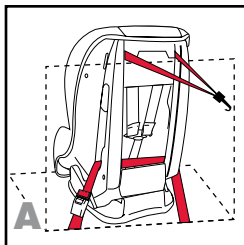

- 3 Pull the vehicle belt out and thread it through the forward-facing belt path to the opposite side of the seat (Fig. C).
- 4 Verify that the vehicle belt is not twisted and buckle (Fig. D).
- 5 Push the child seat firmly into vehicle seat while tightening the vehicle belt.
 - *Ensure the vehicle seat belt system is locked.*
- 6 If the vehicle is equipped with an approved tether anchor, attach the Versa-Tether[®] hook to an approved tether anchor. Remove all slack from tether to secure. Store excess webbing in the tether pouch. See pages 29 – 32.
- 7 Verify that the vehicle belt is tight, locked, and that the child seat is secure.
 - *The child seat is secure when it cannot be moved front-to-back or side-to-side more than 1 inch (2.5 cm.) at the belt path. If the child seat is not secure, repeat the installation process or use an alternate seating location.*



WARNING! Do not use this seat with a two-point Emergency Locking Retractor (ELR) vehicle belt that does not lock.



This child seat is certified for aircraft use. Most airlines in the US and Canada will allow use of a child seat if it is labeled as an approved child seat for airline use and fits properly on plane. Contact the airline about their policy prior to traveling.

Certified for Aircraft Travel

- The FAA recommends that a child weighing up to 40 pounds (18.1 kg) use a certified, harnessed child seat while traveling on an aircraft.
- Install your child seat in a window seat to avoid blocking the aisle.
- If the aircraft lap belt is too short, ask the flight attendant for a belt extender.

Rear-Facing Installation

For rear-facing aircraft installation (Fig. A), follow *Rear-Facing Lap-Belt Installation* instructions on pages 20 - 21.

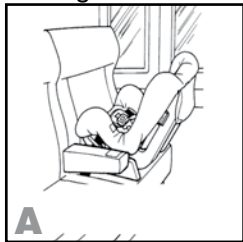

Forward-Facing Installation

For forward-facing aircraft installation (Fig. B), follow *Forward-Facing Lap-Belt Installation* instructions on pages 26 - 27.

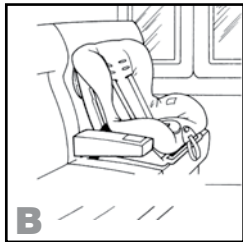

Safety Information



WARNING!

- When using the child seat in forward-facing mode, attach the Versa-Tether only to tether anchors identified by the vehicle manufacturer as tether anchorage points. Use of other locations is not approved or permitted.
- **DO NOT** modify the vehicle without advice from the vehicle manufacturer if a tether anchorage is not available.

IMPORTANT:

- Britax recommends that the tether be used at all times. Using the tether will improve the stability of the child seat and reduce the risk of injury.
- If your vehicle does not currently have a tether anchor attachment, refer to your vehicle owner's manual or contact the vehicle manufacturer for assistance.

Using the Versa-Tether

- 1 Consult your vehicle owner's manual for approved tether anchorage locations.
- 2 Locate the tether on the rear of the child seat and remove the tether components from the pouch. Place the tether up and over the child seat back.
- 3 Install the child seat using the LATCH system or the vehicle belts based on the instructions in this manual.
- 4 Lift the tether release tab; then pull to fully extend the tether strap into a "V" shape.
- 5 Locate the hook on the strap and loosely attach the tether to an anchor point.
 - See figure A for forward-facing installation.
 - See figures B and C for rear-facing installations.
- 6 Secure the child seat by a seat-belt OR with the LATCH connectors.

IMPORTANT: The tether should be hooked over, not under, the vehicle tether anchor.

- 7 Pull the tether adjuster strap to remove all slack.
- 8 Verify there is tension in the tether strap and that the child seat is properly secured.
 - *The child seat is secure when it cannot be moved front-to-back or side-to-side more than 1 inch (2.5 cm.) at the belt path.*

NOTE:

- *The rear-facing recline angle of the child seat should be 30°– 45° from vertical (not to exceed 45°) when car is parked on a level surface (Figs. B and C).*
- *Do NOT use the Versa-Tether to achieve this angle. The rear-facing recline angle can be adjusted by placing a rolled towel or pool noodle in the vehicle seat bight.*

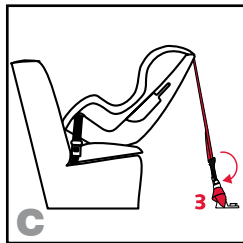
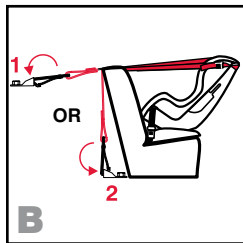
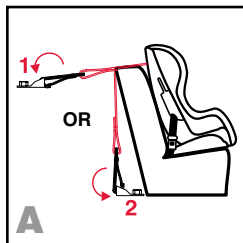

**WARNING!**

Only use the tether connector strap for rear-facing tether installation.

Tether Connector Strap

Because every vehicle model is different, sometimes you cannot find a location to properly anchor the tether. Use the tether connector strap to assist in creating an anchor point (Fig. D).

- 1 Find a fixed vehicle anchor point that is bolted to the floor.
- 2 If you cannot find an acceptable location to create an anchor point, contact the vehicle manufacturer to identify a suitable tether connection point.
- 3 Loop the strap around the metal anchor.
- 4 Take the metal D-ring and thread it through the webbing loop on the other end of the strap.
- 5 Pull the metal D-ring all the way through until the strap is tight around the metal anchor.
- 6 Use the D-ring as an attachment point for hook on tether strap.

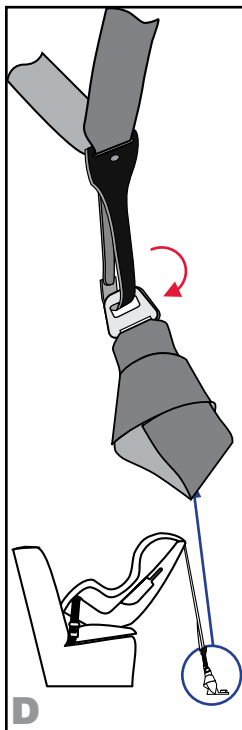

Energy-Absorbing Versa-Tether

The energy-absorbing Versa-Tether was designed to enhance the performance of the child seat tether. By introducing a staged release of the tether webbing, the forward movement of the child seat is delayed while reducing the amount of energy transferred to the child seat during a crash. A secondary benefit of the energy-absorbing Versa-Tether is to help indicate when the child seat has been involved in a moderate or severe crash and replacement of the child seat is necessary.

Figure A shows the tether when the child seat is acceptable for continued use (provided the child seat has not been involved in a crash). The colored stitching will be intact and the webbing will be looped inside the shell.

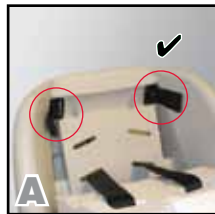

Figures B and C show the tether when the child seat is unacceptable for continued use. If one or both of the loops have pulled through the back side of the shell and/or any of the colored stitching has released on either side, the child seat is no longer acceptable for use. Discontinue use of the child seat.

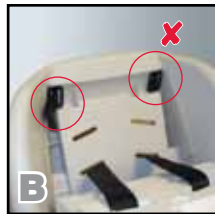

IMPORTANT: *Regardless of whether loops have pulled through the back side of the shell and the colored stitching has been released, discontinue use of the child seat if it has been involved in a moderate or severe crash.*

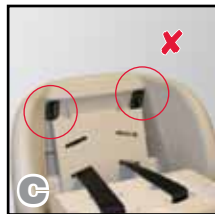

Switching the LATCH Mode

The LATCH connector strap must be switched to the correct belt path for rear-facing (Fig. D) versus forward-facing (Fig. E) installation modes.

Complete the following procedure to switch the LATCH mode.

- 1 Lift the front of the child seat cover to access the LATCH connectors.
- 2 Pull the LATCH strap and connectors from the child's right side of the child seat.
- 3 Thread the LATCH strap and connectors through the appropriate belt path for the installation procedure you wish to use.

IMPORTANT: When installing this child seat in rear-facing mode, the LATCH strap must rest **IN FRONT** OF the child seat buckle when using buckle slots 1 or 2 (Fig. F).

NOTE: To ensure LATCH connector is properly aligned with the vehicle LATCH anchor, the red release button on the connector should face away from the vehicle seat back, and the larger of the two connector sections is on top (Fig. G).

- 4 Replace the cover and continue with LATCH installation procedure.

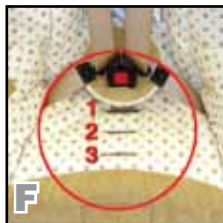
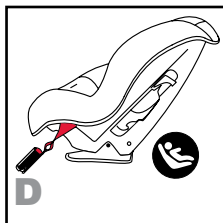

Storing the LATCH Connectors

When the LATCH connectors are not in use, lift the child seat cover to access LATCH storage slots (Fig. A). Fold each end of the LATCH strap and slide each LATCH connector into the adjacent slots.

NOTE: *Britax child seats are shipped with LATCH connectors in the storage slots.*



Recline Adjustment

Pull the recline handle then slide the child seat shell into the desired position. (Fig. B) Release the recline handle and verify the child seat has locked into position.

NOTE: *If installed it will be necessary to loosen the tether, vehicle seat belt, and/or LATCH strap before adjusting the recline position. The tether, vehicle seat belt, and/or LATCH strap must be properly re-tightened after adjusting the recline position.*

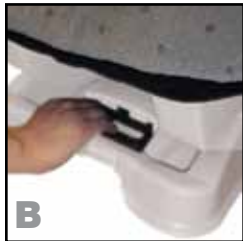

WARNING!

- *This child seat must be in the recline position when installed rear-facing.*
- *Child seat must be in full upright position when installed forward-facing with children who weigh more than 33 lbs (15.1 kg) optional only for rear-facing use.*

Using the Locking Clip

Install child seat into vehicle using instruction through step 5 on pages 16-21 for rear-facing, or pages 22-27 for forward-facing.

NOTE: *Clip is attached and stored on the back of the seat.*

- 1 Push the child seat firmly into the vehicle seat while removing all slack first from the lap portion of the vehicle belt, and then the shoulder portion of the vehicle belt (Fig. A).
- 2 Hold the lap and shoulder belts together just behind the latch plate and unbuckle the vehicle belt without allowing the belt to slip (Fig. A).
- 3 While holding the belts and latch plate, thread the locking clip onto the seat belt (Fig. B) and slide it into place near the latch plate (Fig. C).
- 4 Buckle the seat belt with the locking clip in place.
- 5 Verify that the seat belt is tight and the child seat is secure.
 - *The child seat is secure when it cannot be moved front-to-back or side-to-side more than 1 inch (2.5 cm.) at the belt path. If the child seat is not secure, repeat the installation process or use an alternate seating location.*

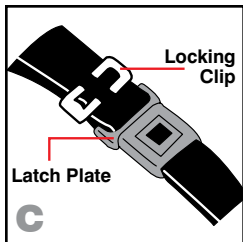
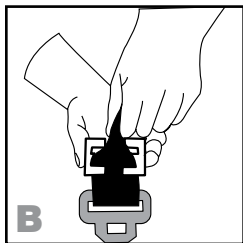
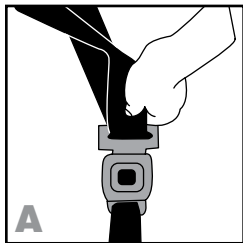

IMPORTANT: *Remove the locking clip from the vehicle seat belt when not used with this child seat, or the vehicle seat belt will not properly restrain a passenger.*

Chest Clip

Fastening the Chest Clip: Fasten the chest clip by pushing the two halves together until a positive click is heard (Fig. A).

Releasing the Chest Clip: Squeeze the middle tab together and pull apart the two pieces (Fig. B).

Adjusting the Chest Clip: Slide chest clip up or down on harness so it is positioned at the middle of the child's chest, level with the child's armpits.

Harness Buckle

Fastening the Harness Buckle: Hold the harness buckle with one hand. Use the other hand to insert one buckle tongue at a time into the harness buckle (Fig. C).

NOTE: Proper connection is confirmed with an audible click after inserting each buckle tongue.

Releasing the Harness Buckle: Brace the rear of the harness buckle with one hand. Press the release button and slide both tongues to remove from the buckle (Fig. D).

IMPORTANT: Periodically clean the harness buckle to ensure safe operation. See pg 44.

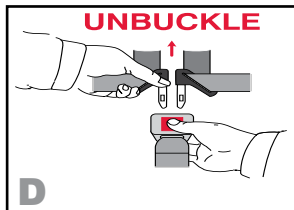
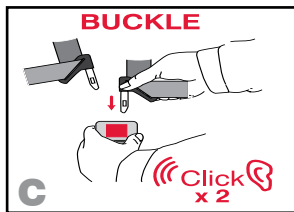
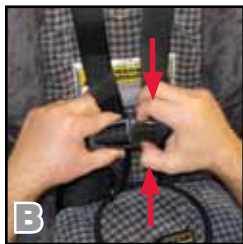

Adjusting Harness Slot Height

IMPORTANT: See *Important Harness Adjustments* on pages 6 – 7 for instructions on proper harness fit based on your child's height and weight.

- 1 Loosen the harness by lifting the harness adjuster lever while pulling both shoulder straps forward as far as possible (Fig. E).
- 2 From the rear of the child seat, unhook the shoulder harness from the harness yoke (Fig. F).
- 3 Pull straps through the shell, foam, and cover to the front of the child seat.
- 4 Thread the harness straps through the appropriate harness slots in the cover, foam, and child seat shell (Fig. G).
- 5 Reattach harness straps to the harness yoke (Fig. F).
- 6 Pull harness adjuster strap to tighten the harness.
- 7 Verify all straps are threaded at the same height and are not twisted.



Adjusting Harness Buckle Position

This child seat allows the buckle to be adjusted to one of three positions based on the weight of the child. Properly adjusting the buckle increases comfort and safety.

IMPORTANT:

- *This child seat is shipped with the buckle in position 1 (Fig. A). Use buckle position 1, 2, or 3 that is closest to but not underneath your child. Do not use buckle position 3 in rear-facing mode.*
- *In rear-facing installations, the LATCH strap or vehicle belt must rest **IN FRONT OF** the child seat buckle when using buckle slots 1 or 2 (Fig. A). If the LATCH strap is not in this position, pull the LATCH strap and connectors from behind the buckle strap and re-thread accordingly.*

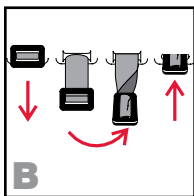
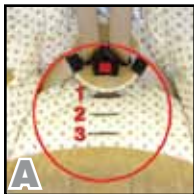

WARNING! This child seat should not be used forward-facing for children less than one year of age and weighing less than 20 lbs (9.1 kgs).

- 1 Recline the child seat.
- 2 Locate the metal buckle strap retainer on bottom of the child seat.
- 3 Pull retainer away from child seat to loosen.
- 4 Turn the retainer so the short side will go through the slot in the child seat shell (Fig. B).
- 5 Push the retainer through slots in the shell and cover to the top of the child seat.
- 6 Locate slot in cover and shell for desired harness buckle location.
- 7 Push the buckle retainer so the short side will go through the slot in the cover and child seat shell.
- 8 Pull harness buckle away from child seat until tight then verify the strap is not twisted and the release button is facing out.

Securing Your Child

Once the child seat has been installed in the vehicle and adjustments have been made, follow these instructions to secure the child.

- 1 Loosen the harness by lifting the harness adjuster lever while pulling both shoulder straps forward (Fig. A).
- 2 Release the chest clip by squeezing the tabs and sliding pieces apart (Fig. B).
- 3 Unfasten the harness buckle by pressing the release button and sliding the tongues out.
- 4 Move the harness straps to the side of the child seat. Use the harness holder located on the straps and side of the cover to aid in holding the straps.
- 5 Place child in the child seat.
- 6 Position the harness straps around the child and fasten the harness buckle (Fig. C) and chest clip (Fig. D).
 - *Proper connection of the harness buckle is confirmed with an audible click after inserting each buckle tongue (see diagram below).*

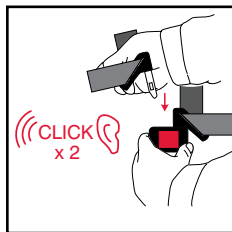
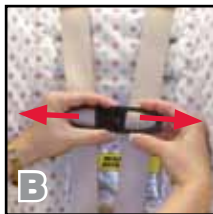

- Gently pull up on the harness straps to tighten the lap section of the harness, which should fit low on the child's body.
- Slowly pull the adjuster strap to tighten the harness around the child (Fig. E).

NOTE: Pull the harness adjuster strap away from the child seat (parallel to the ground) to tighten. Do not pull at a sideways angle (see diagrams below).

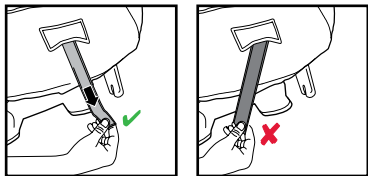

- Position the chest clip at the middle of the child's chest, level with the armpits (Fig. F).
- Verify that harness is not twisted and child is properly secured.

IMPORTANT:

- Always pull on the harness after securing the child to ensure the buckle tongues are secure in the harness buckle. If the buckle will not fasten with an audible click after inserting each buckle tongue, the harness buckle or adjuster area may be clogged with food, drink or other debris that must be removed. See page 43 for cleaning instructions.
- Adjust the belts provided with this child seat so they fit snugly around your child. A snug strap should not allow any slack. It lies in a relatively straight line without sagging. It does not press on the child's flesh or push the child's body into an unnatural position.

Child Seat Cover Removal



WARNING! Do not take apart the harness. Never remove the buckle tongues from the harness. They cannot be reattached after removal. If assembled incorrectly, the child seat may not perform as intended.

- 1 Loosen the harness by lifting the harness adjuster lever while pulling the shoulder straps forward as far as possible.
- 2 Unhook the shoulder straps from the harness yoke on rear of child seat (Fig. A).
- 3 Pull the upper harness straps through the shell and cover to the front of child seat.
- 4 Remove the upper portion of the cover. Be careful not to damage the energy-absorbing foam.
- 5 Remove the buckle and belly pad by turning the metal buckle strap retainer of the buckle on the underside of the child seat so the short side will slide through the child seat shell (Fig. B).
- 6 Push the retainer through the slots in the shell and cover to the top of the child seat.
- 7 Pull the lower harness straps, buckle tongues, and chest clip through lower slots in cover.
- 8 Remove the entire cover from child seat.

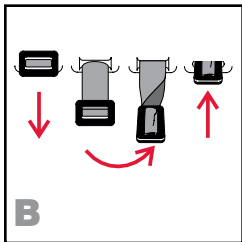

For additional demonstration please visit www.BritaxUSA.com.

Refitting the Cover: To refit the cover, reverse the previous directions. Make sure the shoulder straps are properly threaded through the chest clips and the harness is not twisted.

Harness Buckle Removal

- 1 Recline the child seat.
- 2 Locate the metal buckle strap retainer on bottom of the child seat.
- 3 Pull retainer away from child seat to loosen.
- 4 Turn the retainer so the short side will go through the slot in child seat shell (Fig. A).
- 5 Push the retainer through slots in the shell and cover, to the top of the child seat.

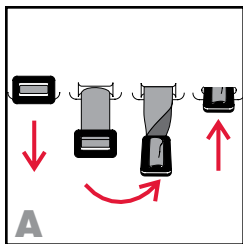

Rethreading the Harness Buckle

IMPORTANT: See *Adjusting Harness Buckle Position* on page 38 for important instructions on proper buckle placement based on your child's size.

- 1 Locate slot in cover and shell for harness buckle.
- 2 Turn the buckle retainer so the short side will go through the slot in the cover and child seat shell (Fig. A).
- 3 Push the retainer through slots in the shell and cover, to the bottom of the child seat.
- 4 Pull harness buckle away from child seat until tight and verify the strap is not twisted and the release button is facing outward.

Cleaning the Cover

- HAND WASH using cold water and mild soap.
- LINE or LIE-FLAT DRY to prevent cover from shrinking.
- **DO NOT** bleach, machine wash, machine dry, or iron the cover.

Cleaning the Shell

- SPONGE CLEAN using warm water and mild soap.
- TOWEL DRY
- **DO NOT** use solvents, abrasive cleaners, or disassemble the harness.

Cleaning the Harness

- SPONGE CLEAN using warm water and mild soap.
- TOWEL DRY
- **DO NOT** bleach, machine wash, machine dry, iron or disassemble the harness.

Cleaning the Harness Buckle

If a child eats and drinks while in the child seat, the harness buckle may need to be periodically checked and cleaned of any accumulated food, drink or other debris.

- REMOVE BUCKLE as described on page 42.
- THOROUGHLY RINSE using warm water (Fig. A).
- TEST THE HARNESS BUCKLE by fastening and unfastening until an audible click is heard after inserting each buckle tongue (Fig. B). If either click is not heard, repeat cleaning procedure.
- TOWEL DRY
- **DO NOT** lubricate, use solvents, abrasive cleaners, soap or other household detergents.

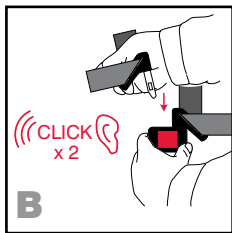
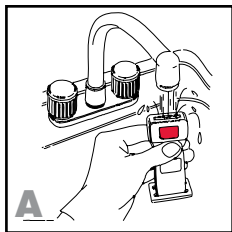



This child seat was manufactured by Britax Child Safety, Inc. Britax® warrants this product to the original retail purchaser as follows:

LIMITED ONE-YEAR WARRANTY

This product is warranted against defective materials or workmanship for one year from the date of original purchase. Proof of purchase is required. The exclusive remedy for this warranty is that Britax will, at its option, provide repair or replacement components for this product or replace the product. Britax reserves the right to discontinue or change fabrics, parts, models or products, or to make substitutions.

To make a claim under this warranty, contact Britax Consumer Services at 1-888-427-4829 or write to us using the address on the back cover of this booklet. Proof of purchase is required.

PLEASE COMPLETE AND MAIL THE OWNER REGISTRATION CARD WITHIN (30) DAYS OF PURCHASE OR VISIT WWW.BRITAXUSA.COM/REGISTRATION.

WARRANTY LIMITATIONS

This warranty does not include damages which arise from negligence, misuse or use not in accordance with the product instruction.

The use of non-Britax Child Safety, Inc. covers, inserts, toys, accessories, or tightening devices is not approved by Britax. Their use could cause this child seat to fail Federal Safety Standards or not perform as intended in a crash. Their use automatically voids the Britax warranty.

LIMITATION OF DAMAGES

The warranty and remedies as set forth above are exclusive and in lieu of all others, oral or written, express or implied. In no event will Britax, or the retailer selling this product, be liable for any damages, including incidental or consequential damages, arising out of the use or inability to use this product.

LIMITATIONS OF WARRANTIES AND OTHER WARRANTY TERMS AND STATE LAWS

Any implied warranties, including implied warranties of merchantability and fitness for a particular purpose, shall be limited to the duration and terms of the express written warranty. Some states do not allow limitations on how long an implied warranty lasts or the exclusion or limitation of incidental or consequential damages, so the above limitations may not apply. This warranty gives you specific legal rights, and you may have other rights, which vary from state to state. Neither Britax, nor the retailer selling this product, authorizes any person to create for it any other warranty, obligation, or liability in connection with this product.

IMPORTANT:

- ☑ **DOUBLE CHECK EVERY TIME YOU USE THIS CAR SEAT.**

Double Check Car Seat-to-Vehicle Installation:

- ☑ Check that the LATCH or vehicle seat belts connections to the vehicle are tight and locked.
- ☑ Verify the car seat cannot be moved front-to-back or side-to-side more than one inch at the belt path.

Double Check Child-to-Car Seat Installation:

- ☑ Tug on the buckle to ensure proper locking.
- ☑ Confirm harness straps are snug and over both shoulders and hips. You should not be able to pinch excess harness strap webbing at the child's shoulder.
- ☑ Make sure the chest clip is properly fastened and positioned in the middle of the child's chest at armpit level.

MADE IN



U. S. A.
WITH GLOBAL COMPONENTS

Britax Child Safety, Inc.
13501 South Ridge Drive
Charlotte, NC 28273
USA

A Britax Childcare Group Limited
company

Tel 1.888.427.4829

www.BritaxUSA.com