



Chaperone™

User Guide







General Information	2
Registration	2
Service Life of Infant Carrier	2
Certification (Motor Vehicle and Aircraft)	3
General Warnings	4
Child Size: Height and Weight Limitations	6
Vehicle Compatibility	7
Using LATCH	7
Connecting the LATCH Connectors	8
Locating and Storing the LATCH Connectors	9
Vehicle Seating Positions	10
Compatible Vehicle Seat Belts	11
Incompatible Vehicle Seat Belts	15
Infant Carrier Features	16
Installing the Base	18
LATCH Installation	18
Lap-Shoulder Belt Installation	24
Lap Belt Installation	28
Attaching Infant Carrier to Base	32
Releasing Infant Carrier from Base	33
Uninstalling the Base	34
Installing Your Infant Carrier without Base	36
Lap-Shoulder Belt Installation	36
Non-Locking Lap-Shoulder Belt Installation Using a Locking Clip	40
Lap Belt Installation	44
Removing the Infant Carrier	46
Securing Your Child	47
Adjusting the Harness	47
Harness Strap Adjustment	49
Adjusting the Buckle	50
Removing the Buckle	50
Replacing the Buckle	52
Low Birth Weight Infant Foam	53
Placing Child in Infant Carrier	54
General Usage	58
Care and Maintenance	60
Troubleshooting	71
Warranty	72



Registration

Fill out the registration card and mail it in today.

Child restraints could be recalled for safety reasons. You must register this restraint to be reached in a recall. Send your name, address, e-mail address if available, and the restraint's model number and manufacturing date to Britax Child Safety, Inc. P.O. Box 91167 Allentown, PA 18109-9925 or call 1-888-4BRITAX or register online at www.BritaxUSA.com/registration. For recall information, call the US Government's Vehicle Safety Hotline at 1-888-327-4236 (TTY: 1-800-424-9153) or go to <http://www.NHTSA.gov>.

Serial Number: _____

Model Number: _____

Batch Number: _____

Date of Manufacture: _____

Service Life of Infant Carrier

To prevent injury due to deterioration or hidden damage, do not use an infant carrier and base that is older than six years or has been in a severe crash. See date of manufacture located on the infant carrier and base.

Certification (Motor Vehicle and Aircraft)



This child seat system conforms to all applicable Federal Motor Vehicle Safety Standards (FMVSS 213).

This Restraint is Certified for Use in Motor Vehicles and Aircraft.

Certified for
Aircraft Travel

Most airlines in the US and Canada will allow the use of a child seat as long as it is labeled as an approved child seat for airline use and fits properly on the aircraft seat. Contact the airline about their policy prior to traveling.

The FAA recommends that a child weighing up to 40 pounds (18.1 kg) use a certified, harnessed child seat while traveling on an aircraft.

Install your child seat in a window seat to avoid blocking the aisle.

If the aircraft lap belt is too short, ask the flight attendant for a belt extender.

For aircraft installation, see Lap Belt Installation instructions without base on pages 44 – 46.

IMPORTANT:

- *Do not use the base on aircraft.*
- *Infant carrier handle must be in any locked position once installed.*

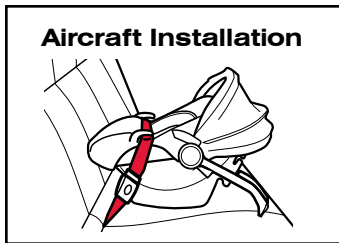



WARNING: DEATH or SERIOUS INJURY can occur:

- *Use only in a rear-facing position when using it in the vehicle.*
- *Use only with children who weigh between 4 and 30 pounds (1.8 and 13.6 kg) and whose height is 32 inches (81.3 cm) or less.*
- *Snugly adjust the belts provided with this child restraint around your child.*
- *Secure this child restraint with the vehicle's child restraint anchorage system if available or with a vehicle belt.*
- *Follow all instructions on this child restraint and in the written instructions located under the cover in the front of the child restraint.*
- *Register your child restraint with the manufacturer.*
- *Consult your child's doctor before using this infant carrier. Some infants must be secured in a device that allows them to lie flat.*
- *Never use the adjuster strap to lift or carry this infant carrier. Doing so could cause damage to the harness adjuster and webbing. Always carry an infant carrier by the handle or shell.*
- *The primary protection for occupants of a vehicle in a collision is the structure of the vehicle; an infant carrier will not protect an infant when the vehicle is seriously impacted. However, correctly installed, an infant carrier will substantially improve the chances for survival in most crashes. Make sure that all users fully understand the correct ways to use this infant carrier in a vehicle.*
- *This infant carrier must not be used in shopping carts, boats, or other non-certified applications.*
- *NEVER leave child unattended.*
- *The use of aftermarket covers, inserts, toys, accessories, or tightening devices is not approved by Britax. Their use could cause this infant carrier to fail Federal Safety Standards or not perform as intended in a crash.*

**WARNING:** DEATH or SERIOUS INJURY can occur:

- *ALWAYS check the back seat upon leaving your vehicle to prevent leaving a child restrained in the infant carrier alone in the vehicle.*
- *NEVER place the occupied infant carrier on beds, sofas, or other soft surfaces. Infant carrier can roll over on soft surfaces and suffocate the child.*
- *NEVER place the occupied infant carrier near edges of counter tops, tables, or other elevated surfaces. Child's movement can slide infant carrier.*
- *ALWAYS use harness when child is in infant carrier. Never leave the occupied infant carrier when straps are loose or undone. A child can strangle in loose infant carrier straps.*
- *NEVER use in or on strollers unless approved by Britax.*
- *ALWAYS lift infant carrier by handle after installation in base to verify that it is secure.*
- *DO NOT leave loose objects, e.g. books, bags, etc., in the back of a vehicle. In the event of a sudden stop, loose objects will keep moving, potentially causing serious injuries.*
- *DO NOT leave folding vehicle seats unlatched. In the event of a sudden stop, a loose seat back could prevent the infant carrier from protecting the child as well as it should.*
- *Cover the infant carrier when the vehicle is parked in direct sunlight. Parts of the infant carrier could become hot enough to burn the child.*
- *DO NOT allow children to play with the infant carrier. Store the infant carrier in a safe place when it is not being used for an extended period of time. Do not place heavy objects on top of it.*
- *To prevent injury due to deterioration or hidden damage, do not use this infant carrier and base if it is older than six years or has been in a moderate or severe crash. See date of manufacture located on the infant carrier and base.*



Infant Carrier Capacities and Limitations

Rear-Facing

Weight 4 – 30 lbs (1.8 – 13.6 kg)

Use rear-facing only with children:

- who weigh between 4 and 30 lbs (1.8 and 13.6 kg) **and**
- who are 32 inches in height (81.3 cm) or less **and**
- when the top of the head is one inch or more below the top of the child seat shell **and**
- when the harness straps are located at the harness height position at or below the child's shoulders.

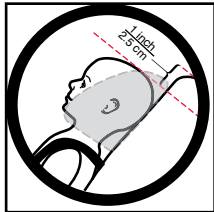

IMPORTANT: See Adjusting the Harness on page 47.



WARNING!

The child has outgrown the infant carrier when:

- *the child exceeds 30 lbs (13.6 kg) in weight* **or**
- *the top of the head is less than one inch from top of the infant carrier* **or**
- *height exceeds 32 inches (81.3 cm).*

Using LATCH

WARNING!

- Use **either** the LATCH system **or** the vehicle belt methods to install this child seat. Using both is not approved and may cause the child seat not to perform as intended.
- Verify that your vehicle is equipped with LATCH anchors. If LATCH anchors are not available, you must use vehicle belt installation methods.
- The LATCH connectors must be in an upright position and the strap should be tight and not twisted to ensure proper installation.

Vehicles manufactured after September 1, 2002 have seating positions equipped with LATCH anchors. If a vehicle is equipped with LATCH, look for the LATCH or tether symbols identifying anchor locations.

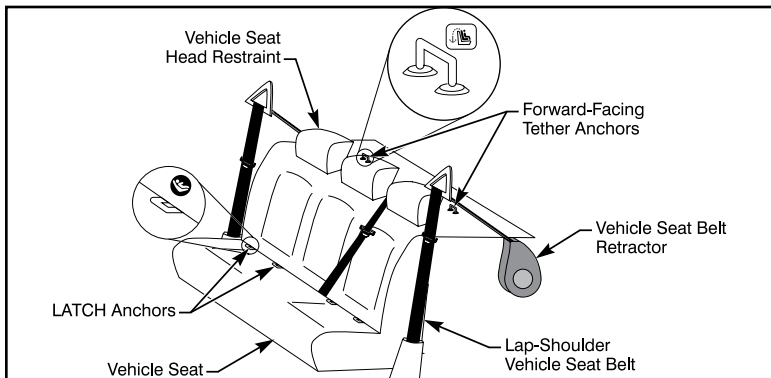

The figure above shows typical locations for lower anchors and tether anchors in a vehicle. Check your vehicle owner's manual for the exact anchor locations, and information on use with an infant carrier.



Only use the LATCH system on this infant carrier in a seating position designated by the vehicle owner's manual. Refer to your vehicle owner's manual or contact the vehicle manufacturer for the maximum weight rating for their LATCH anchors.

This infant carrier was designed to be used with lower LATCH anchors in vehicle designated seating positions. The standard vehicle seat spacing between lower LATCH anchors is 11 inches (27.9 cm). This infant carrier can be used in a seating position with up to 20 inches (50.8 cm) of space between the LATCH anchors if the vehicle manufacturer allows.

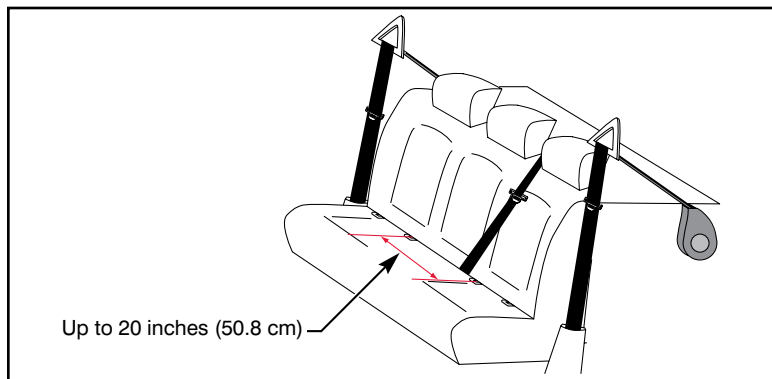

Check your vehicle owner's manual for information on using child restraints in center seating positions without designated LATCH anchors.

Locating and Storing the LATCH Connectors

The LATCH connectors are located on the sides of the base inside the LATCH connector storage slots. Store the LATCH connectors when not in use.

To remove the LATCH connectors from the storage slots:

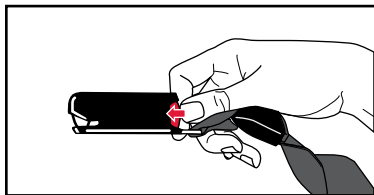

1 Press and hold the red release button.

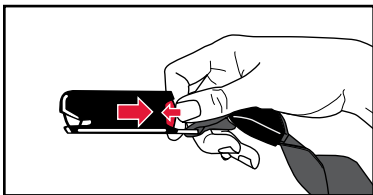

2 Pull the LATCH connector from the storage slot.

To store the LATCH connectors:

Push the LATCH connector into the storage slot until a click is heard to store the LATCH connectors.

NOTE: The LATCH connectors are stored with the “top” facing down.

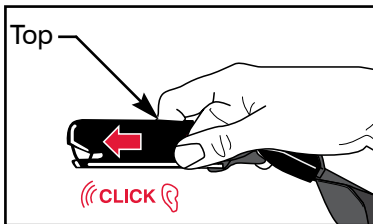

Connecting the LATCH Connectors

The LATCH connectors must be properly aligned with the vehicle LATCH anchors to ensure a proper and secure connection.

Always check that the LATCH connector strap is not twisted and that the LATCH connector is correctly aligned before connecting to the vehicle LATCH anchor.

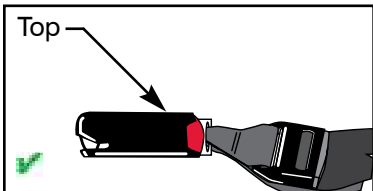
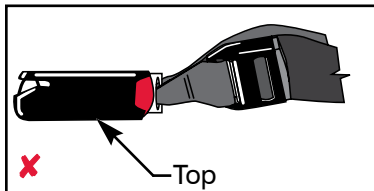

NOTE: Ensure that the “top” of the LATCH connector is facing up when securing the base in your vehicle.

Vehicle Seating Positions

IMPORTANT: *The Chaperone infant carrier and base have been tested to and exceed Federal Motor Vehicle Safety Standards (FMVSS 213). Base overhang may occur and will vary from one vehicle to another.*

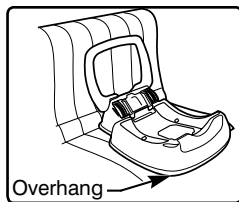

WARNING!



Based on crash statistics, the National Highway Traffic Safety Administration (NHTSA) recommends that parents select the back seat as the safest location for a properly installed infant carrier.

DO NOT place a rear-facing child seat on the front seat with an air bag. **DEATH** or **SERIOUS INJURY** can occur. See your vehicle owner's manual for infant carrier installation instructions. The back seat is the safest place for children 12 and under.

This infant carrier must only be used in forward-facing vehicle seats.

Side-facing or rear-facing seats **CANNOT** be used. If in doubt about installing the infant carrier, consult the vehicle owner's manual.

Some vehicles have no seating positions which are compatible with this infant carrier or any other infant carrier. If in doubt, contact the vehicle manufacturer for assistance. See diagram below.

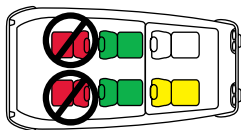
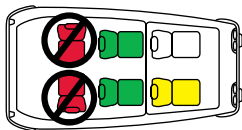

Compatible Vehicle Seat Belts

NOTE: *The information in this section only applies to installation with vehicle safety belts.*

Vehicle seat belts compatible with this child seat are: Lap-shoulder belts and Lap only belts equipped with a switchable retractor, or an automatic locking retractor (ALR), or a locking latch plate.

Vehicle seats and safety belts differ from vehicle to vehicle. Your vehicle owner's manual will have information on the types of vehicle belts in your vehicle. Refer to your vehicle owner's manual for specific information about vehicle safety belts and their use with child seats.

Lap-Shoulder (3 Point) Belt

Switchable Retractor in ALR (Automatic Locking Retractor) Mode with Sliding Latch Plate

- 1 *Has a latch plate that freely slides along the vehicle belt webbing.*
- 2 *Has a retractor that can be switched so that it always locks (Automatic Locking Retractor – ALR) or so it only locks during sudden stops or crashes (Emergency Locking Retractor – ELR).*
 - * To use this infant carrier with this type of vehicle belt, you must switch to the ALR mode or use child seat lock-offs with base or a locking clip with carrier only.

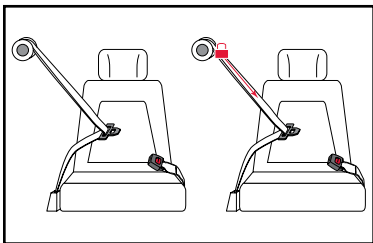
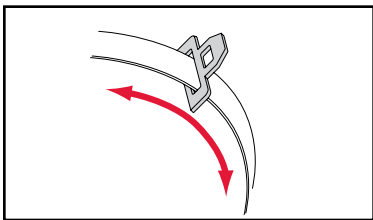

NOTE: *Refer to your vehicle owner's manual to determine the kind of retractors used in your vehicle and how to operate them.*



ALR (Automatic Locking Retractor) with Sliding Latch Plate

- 1 *Has a latch plate that freely slides along the vehicle belt webbing.*
- 2 *Has a retractor that stops the belt from being pulled out again once it has been pulled out.*
 - * The ALR in some vehicle belts may not activate unless the belt is pulled out at least 24 inches (61 cm).
- 3 *Tightens by feeding the belt webbing back into the retractor.*

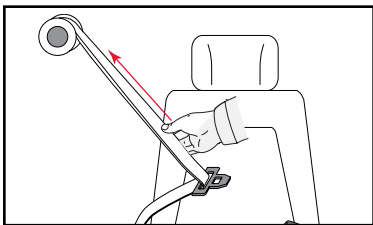
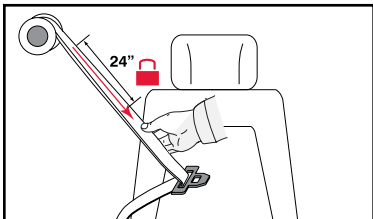
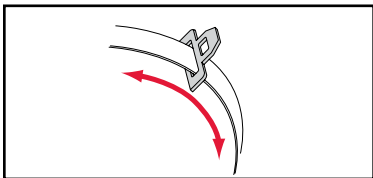

ELR (Emergency Locking Retractor) with Locking Latch Plate

- 1 *Has a latch plate that does not allow the lap part of the belt to become loose after it is buckled.*

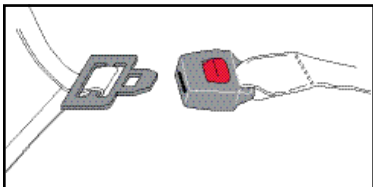

- 2 Has a retractor that locks only in an emergency situation such as sudden stop or crash.

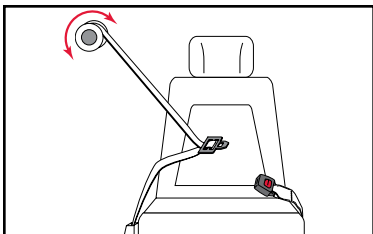

ELR (Emergency Locking Retractor) with a Sliding Latch Plate

- 1 Has a latch plate that freely slides along the vehicle belt webbing.
- 2 Has a retractor that locks only in an emergency situation such as sudden stop or crash. This type of retractor is commonly referred to as an Emergency Locking Retractor or ELR.

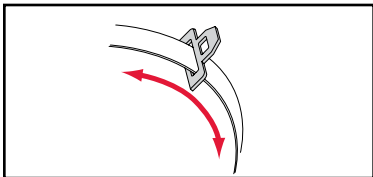

This belt type requires the use of the lock-off built into the base.

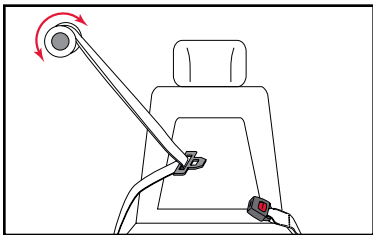

NOTE: The base for this infant carrier is equipped with a lock-off. If installing the carrier without the base, a locking clip must be used with a non-locking lap-shoulder belt. Call Britax Consumer Services at 1.888.427.4829 to obtain a locking clip.

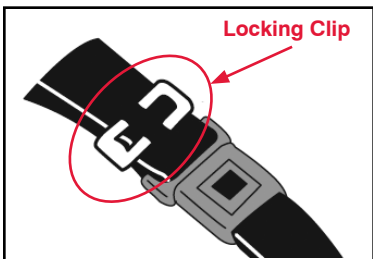



Lap Belt

ALR (Automatic Locking Retractor)

- 1 *Has a latch plate that is sewn onto the webbing.*
- 2 *Has a retractor that stops the belt from being pulled out again once it has been pulled out.*
 - * The ALR in some vehicle belts may not activate unless the belt is pulled out at least 24 inches (61 cm).
- 3 *Tightens by feeding the belt webbing back into the retractor.*

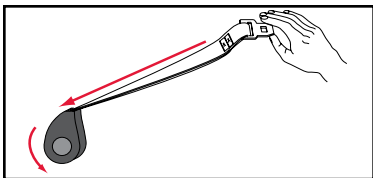
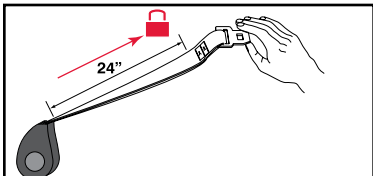
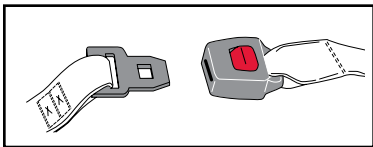

Locking Latch Plate

- 1 *Has a latch plate that does not allow the belt to become loose after it is buckled.*
- 2 *Tightens by pulling on the belt webbing after it is buckled.*

NOTE: Not all locking latch plates look and operate in the same manner. Refer to your vehicle owner's manual to determine the kind of seat belts used in your vehicle and how to operate them with child seats.

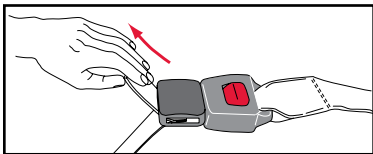
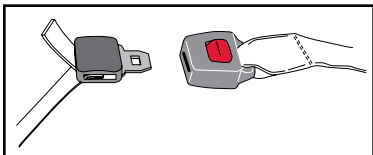



Incompatible Vehicle Seat Belts

WARNING! The following types of vehicle belts are NOT compatible with this child seat:



- 1** *Vehicle belts with top or bottom anchor points on the vehicle door.*

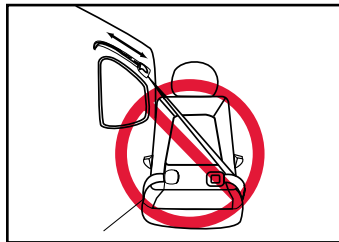

- 2** *Motorized, automatic vehicle belts*

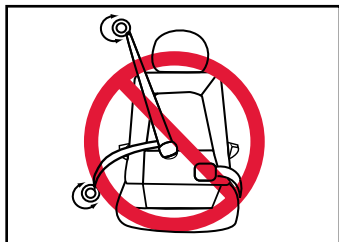

- 3** *Lap-shoulder belts that have a separate retractor each for the lap section and shoulder section.*



- 4** *Lap belts forward of the seat bight*

- 5** *Lap belts that have a retractor that locks only in case of a sudden stop (emergency locking retractor or ELR).*



16 Infant Carrier Features

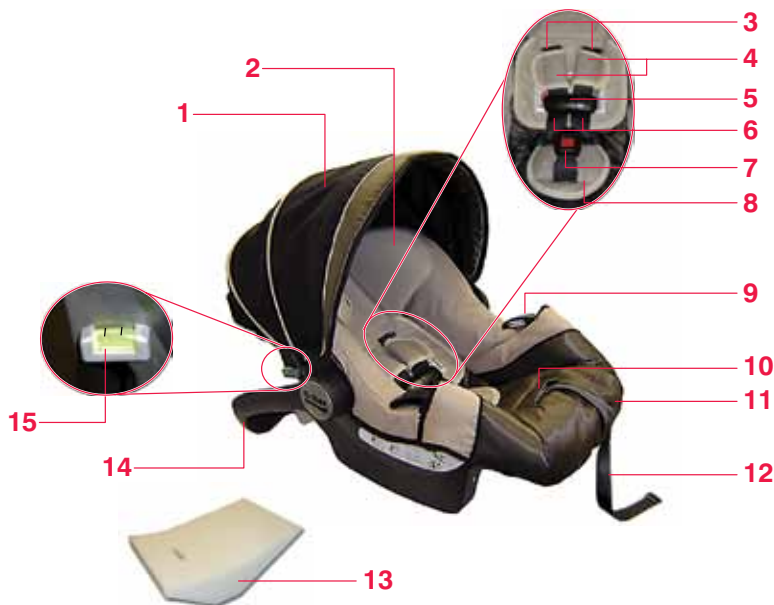

- | | |
|--|--|
| 1 Canopy | 13 Low Birth Weight Infant Foam |
| 2 Head Restraint | 14 Handle |
| 3 Harness Slots | 15 Recline Angle Level Indicator |
| 4 Comfort Pads | 16 Infant Carrier Release Handle |
| 5 Chest Clip | 17 Harness Adjuster |
| 6 Harness Straps | 18 Serial Number and Date of Manufacture Label |
| 7 Buckle | 19 Harness Yoke |
| 8 Belly Pad | 20 Base Belt Guides |
| 9 Carrier Belt Guides | 21 LATCH Adjuster Release Button |
| 10 Harness Adjuster Lever (under button hole slot) | 22 LATCH Adjuster |
| 11 User guide (stored under cover) | 23 LATCH Connector Storage Slot |
| 12 Harness Adjuster Strap | 24 LATCH Connector |



- 25 LATCH Connector Release Button
- 26 Recline Adjustment Foot
- 27 Anti-Rebound Bar
- 28 Carrier Attachment Clips
- 29 Serial Number and Date of Manufacture label (on bottom of base)

- 30 Lock-off
- 31 Recline Adjustment Knob

IMPORTANT: This user guide should be stored under the cover when not in use.



LATCH Installation

WARNING!

- Only raise the base as described in these instructions. Do not use anything to raise the base of the infant carrier off the front edge of the vehicle seat. In a crash, this could cause the infant carrier not to perform as intended.
- The base must ALWAYS be secured in a vehicle as described on pages 18 – 31 before attaching the occupied infant carrier to the base. Never attach the occupied infant carrier to the base unless the base is properly secured in a vehicle.
- Use **either** the LATCH system **or** the vehicle belt methods to install this child seat. Using both is not approved and may cause the child seat not to perform as intended.

Before You Begin:

- ✓ Remove the infant carrier before installing the base.
- ✓ Verify that your vehicle is equipped with LATCH anchors.
- * If your car does not have LATCH anchors, you must use vehicle belt installation methods.

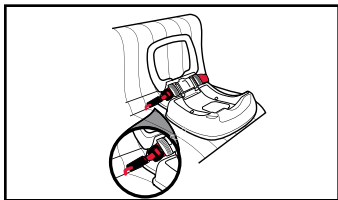

Base Installation with LATCH



1 Press down on the lock off plate, then lift the tabs and lock-off plate to open the lock-off.

2 Press the LATCH adjuster release button while pulling the LATCH strap to loosen the LATCH connector strap.



3 Press and hold the red release button on the LATCH connector while removing the LATCH connectors from the storage slots.

4 Position the base in the desired vehicle seating position equipped with LATCH.



5 Attach each LATCH connector to the adjacent vehicle LATCH anchor by pushing them firmly onto the vehicle LATCH anchors until a click is heard.

6 Pull on the LATCH connectors to verify that the connection is secure.

* Verify that the LATCH connector straps are not twisted.

20 Installing the Base



7 Push the base firmly into the vehicle seat and then pull the LATCH adjuster strap to tighten.

8 Route any loose webbing from the LATCH adjuster through the lock-off.



9 Close the lock-off plate over the webbing.

10 Press firmly on the lock-off plate, and then close both lock-off tabs.

11 Place the infant carrier into the base and press down until a click is heard.

* Pull up on the carrier handle to confirm attachment.



12 Verify that all connections are secure. Check that:

- ✓ The LATCH strap is not twisted.
- ✓ The LATCH connectors are properly aligned.
- ✓ The excess LATCH webbing has been secured in the lock-off.
- ✓ The infant carrier handle is rotated into any locked position.
- ✓ The infant carrier is secure.

* If the base and infant carrier can be moved more than 1 in. (2.5 cm) front-to-back or side-to-side at the LATCH strap path, repeat installation or choose another seating location.



13 Check the recline angle.

14 The proper recline angle is achieved when the level indicators on the infant carrier are within the level lines.

* The vehicle should be parked on a level surface.

IMPORTANT: If a correction is required, do not turn the recline adjustment knob until tension has been removed from the LATCH strap.

NOTE: It may be necessary to install the base more than once to achieve the proper recline angle.



Follow the steps below if adjustment of the recline angle is necessary:



a Press the LATCH adjuster release button to release tension in the LATCH strap.



b Press the LATCH connector release button and detach the LATCH connectors from the LATCH anchors.



c Turn the recline adjustment knob to adjust the recline angle.



d Connect and tighten the LATCH strap.

e Place the infant carrier in the base and check the recline angle.

Repeat the previous steps until a secure fit with proper recline angle is achieved. Continue with installation instructions from step 7 on page 20.

If there is a problem achieving the proper recline angle after following the previous steps:

- f** *Uninstall the base and rotate the recline adjuster on the base to the lowest position.*
- g** *Remove the base from the vehicle seat.*



- h** *Place a rolled towel or pool noodle in the vehicle seat bight.*



- i** *Place the base on the towel or pool noodle to help level the base and continue installation from step 7 on page 20.*



Lap-Shoulder Belt Installation

Before You Begin:

- ✓ Remove the infant carrier before installing the base.
- ✓ Ensure that the LATCH connectors are in the storage slots in the base.
- ✓ Check that your vehicle seat belt is compatible with infant carrier use. See pages 11 – 15 for more information.

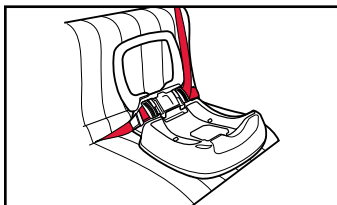

Base Installation with Lap-Shoulder belt



1 Position the base in the desired vehicle seating position.

2 Press down on the lock off plate, then lift the tabs and lock-off plate to open the lock-off.



3 Pull the vehicle belt out and route the lap part under both belt guides.



4 Verify that the vehicle belt is not twisted and then buckle.



- 5** Push the base firmly into the vehicle seat and remove all slack from the lap part of the vehicle belt.



- 6** Pull the shoulder part of the vehicle belt tight and then route under both belt guides.



- 7** Hold the shoulder belt tight and close the lock-off plate over the vehicle belt.



- 8** Press firmly on the lock-off plate, and then close both lock-off tabs.

- 9** Place the infant carrier into the base and press down until a click is heard.

* Pull up on the carrier handle to confirm attachment.



26 Installing the Base



- 10** Verify that the vehicle belt is tight and that the base is secure. The base is secure when it moves less than 1 inch (2.5 cm) front-to-back or side-to-side at the vehicle belt path.
- 11** Verify that all connections are secure. Check that:
- ✓ *The vehicle belt is not twisted.*
 - ✓ *The vehicle belt is tight and locked.*
 - * Check that the vehicle belt has been properly routed through the lock-off and that the lock-off is closed tightly.
 - ✓ *The infant carrier handle is rotated into any locked position.*
 - ✓ *The infant carrier is secure.*
 - * If the base and infant carrier can be moved more than 1 in. (2.5 cm) front-to-back or side-to-side at the vehicle belt path, repeat installation or choose another seating location.



- 12** Check the recline angle.



- 13** The proper recline angle is achieved when the level indicators on the infant carrier are within the level lines.
- * The vehicle should be parked on a level surface.

NOTE: It may be necessary to install the base more than once to achieve the proper recline angle.

Follow the steps below if adjustment of the recline angle is necessary:

- a** *Unbuckle the seat belt.*
- b** *Turn the recline adjustment knob to adjust the recline angle.*



- c** *Place the infant carrier in the base and check the recline angle.*

Repeat the previous steps until a secure installation with proper recline angle is achieved. Continue with installation instructions from step 3.

If there is a problem achieving the proper recline angle after following the previous steps:

- d** *Uninstall the base and rotate the recline adjuster on the base to the lowest position.*
- e** *Remove the base from the vehicle seat.*



- f** *Place a rolled towel or pool noodle in the vehicle seat bight.*



- g** *Place the base on the towel or pool noodle to help level the base and continue installation from step 3 on page 24.*



Lap Belt Installation

Before You Begin:

- ✓ *Remove the infant carrier before installing the base, if attached.*
- ✓ *Ensure that the LATCH connectors are in the storage slots in the base.*
- ✓ *Check that your vehicle seat belt is compatible with infant carrier use. See pages 11 – 15 for more information.*

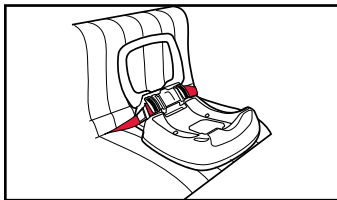

Base Installation with Lap Belt



- 1** *Position the base in the desired vehicle seating position.*



- 2** *Press down on the lock off plate, then lift the tabs and lock-off plate to open the lock-off.*



- 3** *Pull the vehicle belt out and route under both belt guides.*



- 4** *Verify that the vehicle belt is not twisted and then buckle.*



- 5** Push the base firmly into the vehicle seat while removing all slack from the vehicle belt.



- 6** Route any excess webbing from the vehicle belt through the lock-off.



- 7** Close the lock-off plate over the webbing and close both lock-off tabs while pressing firmly on the lock-off plate.
- * The lock-off is properly secured when the tabs lay flat against the lock-off plate.
 - * If the lock-off will not close, remove the excess vehicle belt webbing and tuck it under the base.



- 8** Place the infant carrier into the base and press down until a click is heard.
- * Pull up on the carrier handle to confirm attachment.

- 9** Verify that the vehicle belt is tight and that the base is secure. The base is secure when it moves less than 1 inch (2.5 cm) front-to-back or side-to-side at the vehicle belt path.



10 Verify that all connections are secure. Check that:

- ✓ *The vehicle belt is not twisted.*
- ✓ *The vehicle belt is tight and locked.*
 - * Check that the vehicle belt retractor is locked or,
 - * Check that the vehicle belt has been properly routed through the lock-off and that the lock-off is closed.
- ✓ *The infant carrier handle is rotated into any locked position.*
- ✓ *The infant carrier is secure.*
 - * If the base and infant carrier can be moved more than 1 in. (2.5 cm) front-to-back or side-to-side at the vehicle belt path, repeat installation or choose another seating location.



11 Check the recline angle.



12 The proper recline angle is achieved when the level indicators on the infant carrier are within the level lines.

- * The vehicle should be parked on a level surface.

NOTE: It may be necessary to install the base more than once to achieve the proper recline angle.

Follow the steps below if adjustment of the recline angle is necessary:

- a** *Unbuckle the seat belt.*
- b** *Turn the recline adjustment knob to adjust the recline angle.*



- c** *Place the infant carrier in the base and check the recline angle.*

Repeat the previous steps until a secure installation with proper recline angle is achieved. Continue with installation instructions from step 3.

If there is a problem achieving the proper recline angle after following the previous steps:

- d** *Uninstall the base and rotate the recline adjuster on the base to the lowest position.*
- e** *Remove the base from the vehicle seat.*



- f** *Place a rolled towel or pool noodle in the vehicle seat bight.*



- g** *Place the base on the towel or pool noodle to help level the base and continue installation from step 3 on page 28.*



Attaching Infant Carrier to Base



1 *Align the infant carrier with the slots in the base, ensuring that the infant carrier faces the rear of the vehicle.*

2 *Set the infant carrier into base until an audible click is heard.*

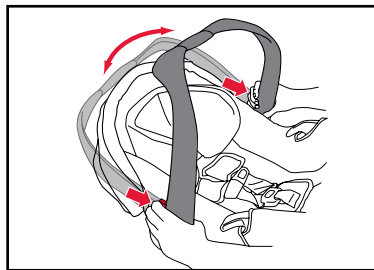

3 *Pull up on the infant carrier handle to ensure it is properly secured.*

4 *Rotate the handle to any locked position.*



Releasing Infant Carrier from Base

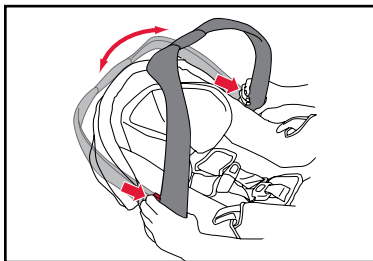

1 *If necessary, rotate the handle into the carrying position.*



2 *Locate the release handle at the rear of the infant carrier.*



3 *Squeeze and hold the release handle.*



4 *Lift the infant carrier away from the base.*



Removal of Base

LATCH Installation:

IMPORTANT: Always remove the infant carrier before attempting to remove the base.



1 Press down on the lock off plate, then lift the tabs and lock-off plate to open the lock-off.



2 Press the LATCH adjuster release button and release tension in the LATCH strap.

3 Press the LATCH connector release button on each connector and detach them from the LATCH anchors.

4 Remove the base from the vehicle.



Removal of Base

Vehicle Belt Installation:

IMPORTANT: Always remove the infant carrier before attempting to remove the base.



1 Lift the tabs and lock-off plate to open the lock-off.



2 Press the release button on the vehicle belt buckle.

3 Pull the vehicle belt from the base belt guides.

4 Remove the base from the vehicle.





Installation without Base

Lap-Shoulder Belt Installation

Before You Begin:

- ✓ *Check that your vehicle seat belt is compatible with infant carrier use. See pages 11 – 15 for more information.*
- ✓ *Check your vehicle owner's manual to determine how to lock your vehicle belt system.*
- ✓ *Secure child in carrier before installing carrier in vehicle.*

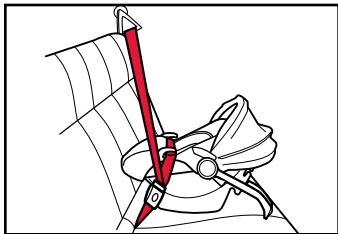

Carrier Installation with Lap Shoulder Belt



- 1** *Place the infant carrier rear-facing on the vehicle seat.*



- 2** *Pull the vehicle belt out and route the lap part of the vehicle belt through the first belt guide.*

* *Do not route the shoulder part of the vehicle belt through the belt guides.*



- 3** Route the lap part of the vehicle belt through the second belt guide.

* Do not route the shoulder part of the vehicle belt through the belt guides.

- 4** Verify that the vehicle belt is not twisted and then buckle.

- 5** Lock your vehicle seat belt system as instructed by your vehicle owner's manual.

* See pages 11 – 15 for more information.

- 6** Push the infant carrier firmly into the vehicle seat while removing all slack from the lap part and then the shoulder part of the vehicle belt.



IMPORTANT: If you cannot lock your vehicle seat belt you must use a locking clip. See pages 40 – 43. Contact Britax Consumer Services at 1.888.427.4829 to obtain a locking clip.

38 Installing Your Infant Carrier without Base



- 7 *Adjust the infant carrier handle to any locked position.*

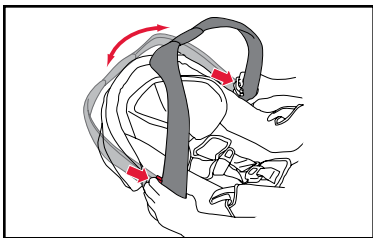

- 8 *Verify that all connections are secure. Check that:*

✓ *The vehicle belt is not twisted.*

✓ *The vehicle belt is tight and locked.*

- * Check that the vehicle belt retractor is locked or,
- * Check that the latch plate is locked or,
- * Ensure that a locking clip has been properly installed.

✓ *The infant carrier handle is rotated into any locked position.*

✓ *The infant carrier is secure.*

- * If the infant carrier can be moved more than 1 in. (2.5 cm) front-to-back or side-to-side at the vehicle belt path, repeat installation or choose another seating location.



- 9 *Check the recline angle.*



- 10 *The proper recline angle is achieved when the level indicators on the infant carrier are within the level lines.*

- * The vehicle should be parked on a level surface.

NOTE: *It may be necessary to install the infant carrier more than once to achieve the proper recline angle.*

Follow the steps below if adjustment of the recline angle is necessary:

- a** *Unbuckle the seat belt.*



- b** *Place a rolled towel or pool noodle(s) in the vehicle seat bight.*

* See note below.



- c** *Place the infant carrier on the towel or pool noodle(s) to help level the base.*

Repeat the previous steps until a secure installation with proper recline angle is achieved. Continue with installation instructions from step 2 on page 36.

NOTE: *Configure pool noodle(s) to accommodate variations in vehicle seat contour as necessary.*



Non-Locking Lap-Shoulder Belt Installation Using a Locking Clip

IMPORTANT: When installing this restraint using a non-locking vehicle belt, a locking clip **must** be used. Refer to your vehicle owner's manual for instructions on correct use of vehicle belts with child seats.

Before You Begin:

- ✓ Ensure you have a locking clip. Contact Britax Consumer Services at 1.888.427.4829 to obtain a locking clip.
- ✓ Secure child in carrier before installing carrier in vehicle

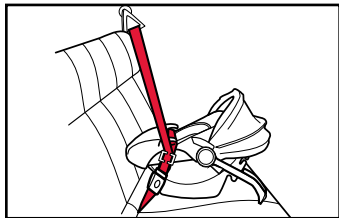

Carrier Installation with a Non-Locking Lap-Shoulder Belt



1 Place the infant carrier rear-facing on the vehicle seat.



2 Pull the vehicle belt out and route the lap part of the vehicle belt through the first belt guide.

- * Do not route the shoulder part of the vehicle belt through the belt guides.



3 *Route the lap part of the vehicle belt through the second belt guide.*

***** Do not route the shoulder part of the vehicle belt through the belt guides.



4 *Verify that the vehicle belt is not twisted and then buckle.*



5 *Push the infant carrier firmly into the vehicle seat while removing all slack from the lap part, and then the shoulder part of the vehicle belt.*



6 *Hold the lap and shoulder belts together behind the latch plate and unbuckle.*

7 *Thread the locking clip onto both belts, placing it within 1 inch (2.5 cm) of the latch plate.*



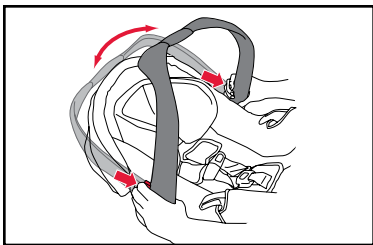

- 8** *Buckle the vehicle belt.*
- * The vehicle belt should be tight around the infant carrier. If it is not tight, unbuckle the belt, remove the locking clip, and repeat steps 2 – 7.
- 9** *Adjust the infant carrier handle to any locked position.*
- 10** *Verify that all connections are secure. Check that:*
- ✓ *The vehicle belt is not twisted.*
 - ✓ *The vehicle belt is tight and locked.*
 - * Ensure that a locking clip has been properly installed.
 - ✓ *The infant carrier handle is rotated into any locked position.*
 - ✓ *The infant carrier is secure.*
 - * If the infant carrier can be moved more than 1 in. (2.5 cm) front-to-back or side-to-side at the vehicle belt path, repeat installation or choose another seating location.

- 11** *Check the recline angle.*



12 *The proper recline angle is achieved when the level indicators on the infant carrier are within the level lines.*

- * The vehicle should be parked on a level surface.



NOTE: *It may be necessary to install the infant carrier more than once to achieve the proper recline angle.*

Follow the steps below if adjustment of the recline angle is necessary:

- a** *Unbuckle the seat belt.*



- b** *Place a rolled towel or pool noodle(s) in the vehicle seat bight.*

- * See note below.



- c** *Place the infant carrier on the towel or pool noodle(s) to help level the base.*

Repeat the previous steps until a secure installation with proper recline angle is achieved. Continue with installation instructions from step 2 on page 40.

NOTE: *Configure pool noodle(s) to accommodate variations in vehicle seat contour as necessary.*



Lap Belt Installation

Before You Begin

- ✓ Check your vehicle owner's manual to see if your seat belt is compatible with infant carrier use. See pages 11 – 15 for more information.
- ✓ There are many different types of lap belts. Check your vehicle owner's manual to determine how to lock your vehicle belt system.
- ✓ Secure child in carrier before installing carrier in vehicle.

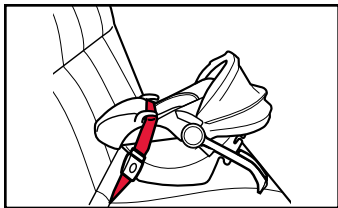

Carrier Installation with Lap Belt



- 1** Place the infant carrier rear-facing on the vehicle seat.



- 2** Pull the vehicle belt out and route the vehicle belt under both belt guides.



- 3** Verify that the vehicle belt is not twisted and then buckle.



- 4** Push the infant carrier firmly into the vehicle seat while removing all slack from the vehicle belt.

- 5 *Adjust the infant carrier handle to any locked position.*

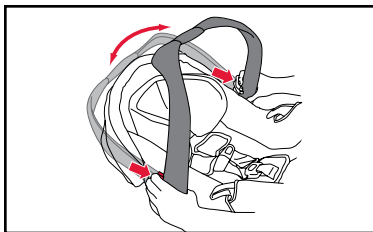

- 6 *Verify that all connections are secure. Check that:*

✓ *The vehicle belt is not twisted.*

✓ *The vehicle belt is tight and locked.*

* There are many different types of lap belts. Check your vehicle owner's manual for installation instructions with child restraints.

✓ *The recline level indicator is within the level lines.*

✓ *The infant carrier handle is rotated into any locked position.*

✓ *The infant carrier is stable.*

* If the infant carrier can be moved more than 1 in. (2.5 cm) front-to-back or side-to-side at the vehicle belt path, repeat installation or choose another seating location.



- 7 *Check the recline angle.*



- 8 *The proper recline angle is achieved when the level indicators on the infant carrier are within the level lines.*

* The vehicle should be parked on a level surface.

NOTE: *It may be necessary to install the infant carrier more than once to achieve the proper recline angle.*



Follow the steps below if adjustment of the recline angle is necessary:

- a** *Unbuckle the seat belt.*



- b** *Place a rolled towel or pool noodle(s) in the vehicle seat bight.*

* See note below.



- c** *Place the infant carrier on the towel or pool noodle(s) to help level the base.*

Repeat the previous steps until a secure installation with proper recline angle is achieved. Continue with installation instructions from step 2 on page 44.

NOTE: *Configure pool noodle(s) to accommodate variations in vehicle seat contour as necessary.*

Removing the Infant Carrier

- 1 Unbuckle the vehicle belt.*
- 2 Pull the vehicle belt from the infant carrier belt guides.*

IMPORTANT: *If you have installed the infant carrier using a locking clip, ensure that the locking clip is removed before the vehicle belt is used by a passenger not riding in a child restraint.*

Securing Your Child in the Infant Carrier



WARNING!

- Adjust harness to fit clothes the child is wearing. Remove bulky coats and/or jackets before putting child in infant carrier.
- Adjust the belts provided with this child seat so they fit snugly around your child. A snug strap should not allow any slack. It lies in a relatively straight line without sagging. It does not press on the child's flesh or push the child's body into an unnatural position.
- Verify that the infant carrier is secure and that the harness is properly adjusted around the child **EACH** time the infant carrier is used. Failure to properly adjust the harness could result in death or serious injury.

Adjusting the Harness

The harness should be properly adjusted to fit your child prior to installing the infant carrier in your vehicle. Follow the steps below to prepare the infant carrier harness for use with your child.

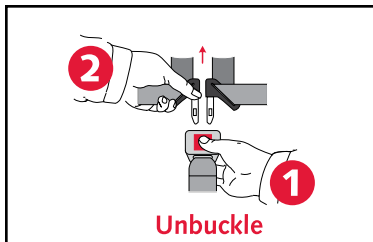

- 1 Press the red release button and pull the buckle tongues from the buckle to unbuckle the harness.

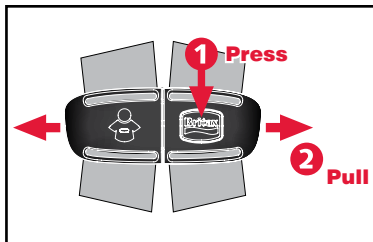

- 2 Press the release button and pull the two halves apart to release the chest clip.



Rear-Facing
Strap Height

- 3 Move the harness straps to the side of the infant carrier.
- 4 Move the buckle away from the seating area of the infant carrier.
- 5 Place the child in the infant carrier and check the harness height.
 - * The correct height for the harness straps is at or below the child's shoulders.

If the harness straps need height adjustment follow the steps below:

- a Lift the harness height adjuster on the back of the infant carrier.
- b Slide the harness height adjuster up or down into the nearest position at or below your child's shoulders.
- c The harness height adjuster will lock into place once released.



NOTE: The head restraint and harness strap adjustment is controlled by the harness height adjuster on the back of the infant carrier shell. The head restraint will be at the correct height adjustment once the harness straps are correctly positioned for your child.

Harness Strap Adjustment

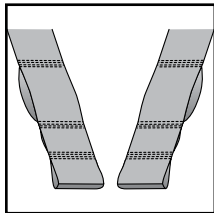

When using the infant carrier for a child 11 lbs (5 kg) or below, the inner harness strap loops must be used. For a child above 11 lbs (5 kg), the end loops of the harness strap must be used. See page 50.

Depending on the size of your child, you will need to adjust the shoulder straps on the harness to ensure the harness provides the most snug fit around your child. See page 50 for important information for adjusting the buckle position for the fit of your child.

A snug strap should not allow any slack. It lies in a relatively straight line without sagging. It does not press on the child's flesh or push the child's body into an unnatural position.

To Adjust the Shoulder Straps of the Harness:



- 1 Locate the harness yoke on the back of the infant carrier shell.
- 2 Slide the harness straps from the harness yoke.
- 3 Select the appropriate loop on the harness strap for the size of your infant.
 - * Use the inner loops for infants 11 lbs (5 kg) and under, and the end loops for infants 11 lbs (5 kg) and over.
 - * **DO NOT use the middle section between the end and inner loops.**
- 4 Slide the harness strap onto the harness yoke.

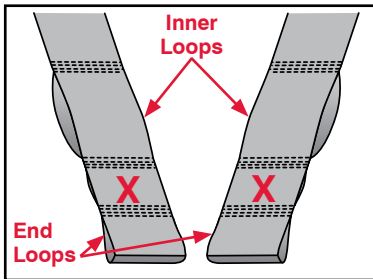



IMPORTANT: *Harness straps must hang as shown by ✓ above. Do not tuck the straps behind the harness yoke. Pull on the harness straps to ensure the harness strap webbing is secured within the slots of the harness yoke.*

Adjusting the Buckle

IMPORTANT: *Your infant carrier has been assembled with the buckle strap in the inner position for infants weighing less than 11 lbs (5 kg). Once your child reaches 11 lbs (5 kg) re-route the buckle position to the outer slot. Follow the steps below to adjust the buckle position. See page 49 for important information for adjusting the harness straps for the fit of your child.*

Removing the Buckle

- 1 *Remove the infant carrier from the base if attached.*



- 2 *Pull the plastic flaps on the cover from the infant carrier shell.*
- 3 *Pull the infant carrier cover and foam back to access the buckle slots.*



4 Locate the buckle strap retainer attached to the opposite end of the buckle strap on the bottom of the infant carrier shell.



5 Slide the retainer from the tabs on the bottom of the infant carrier shell, then pull the buckle strap retainer away from the infant carrier to loosen.



6 Turn the buckle strap retainer so the short side will go through the slot in the infant carrier shell.



7 Pull the buckle strap retainer through the slots in the infant carrier shell, foam and cover.



Replacing the Buckle



- 1** Turn the buckle strap retainer so that the short side will go through the desired slots in the cover, foam and infant carrier shell.
- 2** Thread the buckle strap retainer through the desired slots in the infant carrier shell.



- 3** Slide the buckle strap retainer into the tabs so it lies flat against the infant carrier shell.
- 4** Check that the buckle strap is not twisted and that the red release button faces out.



Low Birth Weight Infant Foam

Low birth weight foam has been included with this infant carrier for infants weighing 4 to 11 lbs (1.8 to 5 kg). This foam may be necessary for low birth weight infants to achieve a snug fit of the harness around your child.

IMPORTANT: Do not use low birth weight foam for infants weighing more than 11 lbs (5 kg). Always use inner buckle strap slot when using low birth weight infant foam see pages 50 – 52.

To use the Low Birth Weight Infant Foam:



- 1** Pull the plastic flaps on the cover from the infant carrier shell.



- 2** Pull the infant carrier cover and foam back to access the buckle slots.



- 3** Slide the foam into place around the buckle slots.

* The buckle can be removed as described on pages 50 – 51 for easier placement of the foam.



- 4** If the buckle was removed, thread the buckle retainer through the slot in the foam insert, foam pad, and infant carrier shell.

* Ensure the buckle retainer lies flat against the infant carrier shell.

- 5** Replace the cover.



Placing Child in Infant Carrier



- 1** *Press the harness adjuster lever while pulling both harness straps forward to loosen the harness.*

- 2** *Press the tab and pull apart the two halves to release the chest clip.*



- 3** *Press the red release button on the buckle and pull the tongues from the buckle to unbuckle the harness.*

- 4** *Move the harness straps to the sides of the infant carrier.*

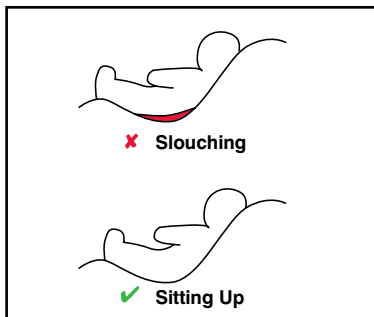

- 5** Place the child in the infant carrier as shown.



- 6** Position the harness straps around the child.



- 7** Insert one buckle tongue at a time into the harness buckle to buckle the harness.
- * Connection is confirmed with a click after inserting each buckle tongue.
 - * Always pull on the buckle to ensure the buckle is properly connected.



- 8** Slide the two halves of the chest clip together until a click is heard to fasten the chest clip.



- 9 Gently pull up on the harness straps to tighten the lap section of the harness, which should fit low on the child's body.



- 10 Slowly pull the adjuster strap to tighten the harness around the child.

NOTE: Snugly adjust the belts provided with this child restraint around your child. A snug strap should not allow any slack. It lies in a relatively straight line without sagging. It does not press on the child's flesh or push the child's body into an unnatural position.



Pull the harness adjuster away from the child seat (parallel to the ground) to tighten.



Do not pull at a sideways angle.



- 11** *Position the chest clip at the center of the child's chest, level with the child's armpits.*



- 12** *Verify that the harness is not twisted and the child is properly secured. Check that the:*

- ✓ *Buckle is fastened*
- ✓ *Harness straps are not twisted.*
- ✓ *Harness is snug*
- ✓ *Chest clip is at the child's armpit level.*

IMPORTANT:

- *Always pull on the harness after securing the child to make sure the buckle and harness are locked. The buckle or adjuster area can become clogged with food, drink, or objects that need to be removed. See pages 68 – 70 for cleaning instructions.*
- *Always make sure that the harness is tight before each use, or after any adjustments.*



Handle Positions

The carrier handle must be adjusted to one of the three locked positions. To adjust, press and hold both handle release levers and rotate the handle into one of the three locked positions.

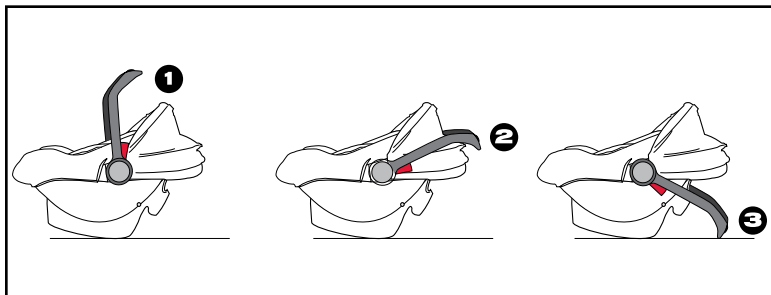

Canopy



1 To raise the canopy, pull the canopy fabric at the top of the canopy arch toward the bottom of the infant carrier.

2 To collapse the canopy, push the canopy fabric at top of canopy arch in toward the top of the infant carrier.



User Guide Storage

Tuck the user guide and lanyard under the cover in the front of the infant carrier to store.



Seat Storage

Store the infant carrier in a safe, dry place when it will not be used for an extended period of time. Do not place heavy objects on top of it. Cover the infant carrier to help keep it clean. Remove and wash the cover and canopy (see instructions on pages 60 – 65) before using the seat the first time after storage.

Transporting an Unoccupied Infant Carrier

Attach this infant carrier to a securely installed base or install the infant carrier with a vehicle seat belt without the base even when it is not occupied. In a crash, an unsecured infant carrier may injure occupants in your vehicle. See pages 18 – 46 for installation instructions.



Cover Removal

WARNING!

- *DO NOT, except as described in this booklet, attempt to disassemble any part of the infant carrier or change the way its harness or the vehicle belts are used.*
- *DO NOT take apart the harness. It is unnecessary and dangerous to do so.*
- *Never remove the buckle tongues from the harness. They cannot be reattached after removal.*



- 1** *Unhook the canopy stays from the carrier handle to remove the canopy.*



- 2** *Unhook the cover attachment flaps.*
- 3** *Remove the Infant carrier from the base if attached.*

- 4** *Press the harness adjuster release lever and pull both harness straps forward to loosen the harness.*





- 5** Press the red release button on the buckle and pull the tongues from the buckle to unbuckle the harness.



- 6** Unhook the harness straps from the harness yoke on the bottom of the infant carrier.



- 7** Pull the harness straps through the shell, cover, and head restraint.



- 8** Remove the head restraint cover.
* Be careful not to damage the EPS foam.

- 9** Pull the infant carrier cover and foam back so the buckle slots are visible.





10 Locate the buckle strap retainer attached to the opposite end of the buckle strap.



11 Slide the buckle strap retainer from the tabs on the bottom of the infant carrier shell, then pull the buckle strap retainer away from the infant carrier to loosen.



12 Turn the buckle strap retainer so that the short side will go through the slots in the infant carrier shell.



13 Pull the buckle strap retainer through the slots in the infant carrier shell, foam and cover.

14 Pull the belly pad over the buckle strap retainer to remove.





15 Remove the comfort pads from the harness straps.



16 Remove the top part of the cover.
* Be careful not to damage the EPS foam.



17 Pull the harness straps, buckle tongues, and chest clip through the slots in the cover.



18 Remove cover from the infant carrier.



Refitting the Cover:



- 1 *Route the top part of the cover over the infant carrier shell.*

* Be careful not to damage the EPS foam.

- 2 *Pull the harness straps, chest clips, and buckle tongues through the slots in the cover.*

- 3 *Turn the buckle strap retainer so the short side will fit through the desired slots in the cover, foam and infant carrier shell to replace the buckle.*



IMPORTANT: Your infant carrier has been assembled with the buckle strap in the inner position, and the harness straps adjusted to the inner strap loops for infants weighing less than 11 lbs (5 kg). Once your child reaches 11 lbs (5 kg) re-route the buckle position to the outer slot and adjust the harness straps to the end loops for the remainder of use with that child. Follow the procedures below to adjust the buckle position. See pages 49 – 52 for instructions on removing and replacing the buckle and adjusting the harness strap loops.



4 Thread the buckle strap retainer through the desired slots in the infant carrier shell.

5 Slide the buckle strap retainer into the tabs so it lies flat against the infant carrier shell.



6 Check that the buckle strap is not twisted and that the red release button faces out.



7 Pull the adjuster strap through the slot in the cover.

8 Route the lower part of the cover over the child seat shell.





- 9** *Fit the plastic flaps under the edge of the child seat shell.*



- 10** *Replace the comfort pads on the harness straps.*



- 11** *Replace the head restraint cover.*
- * Be careful not to damage the energy absorbing foam.
 - * Ensure the slots are aligned in the head restraint cover, comfort foam, and infant carrier shell.



- 12** *Route the harness straps through the head restraint cover, comfort foam, and infant carrier shell.*

- 13** *Attach the harness straps to the harness yoke.*
- * Ensure the harness straps are not twisted.
 - * See pages 49-50 for information on which harness strap loops to use.



- 14** *Before using the infant carrier, double check that the harness straps are not twisted, and that the comfort pads, chest clip, and buckle tongues appear as shown.*



Cleaning the Cover

- HAND WASH using cold water and mild soap.
- LINE DRY to prevent cover from shrinking.
- **DO NOT:**
 - * Bleach
 - * Machine Wash
 - * Machine Dry
 - * Iron

Cleaning the Shell & Harness

- BRUSH AWAY LOOSE DEBRIS using a soft bristled brush.
- SPONGE CLEAN using warm water and mild soap.
- TOWEL DRY
- **DO NOT:**
 - * Use solvents
 - * Use abrasive cleaners
 - * Bleach
 - * Machine wash
 - * Machine dry
 - * Disassemble the harness
 - * Iron



Cleaning the Harness Adjuster

- BRUSH AWAY LOOSE DEBRIS using a soft bristled brush.
- SPONGE CLEAN using warm water and mild soap.
- TOWEL DRY
- **DO NOT:**
 - * Use solvents
 - * Use abrasive cleaners
 - * Disassemble the harness adjuster
 - * Iron

NOTE: Periodically check the harness adjuster area to be sure it is clean and free of food, coins, dirt, or other debris. Remove any debris to prevent interference with the harness adjuster mechanism.

Cleaning the Buckle

Remove the Buckle

- 1 Remove the infant carrier from the base if attached.



- 2 Pull the infant carrier cover and foam back so the buckle slots are visible.



- 3 Locate the buckle strap retainer attached to the opposite end of the buckle strap on the bottom of the infant carrier shell.



4 Slide the retainer from the tabs on the bottom of the infant carrier shell, then pull the buckle strap retainer away from the infant carrier to loosen.

6 Pull the buckle strap retainer through the slots in the infant carrier shell, foam and cover.
* Pull the belly pad over the metal retainer to remove.



5 Turn the buckle strap retainer so that the short side will go through the slot in the infant carrier shell.



Clean the Buckle

- RINSE THOROUGHLY using warm water.
- TEST THE BUCKLE by fastening and unfastening until a click is heard after inserting each buckle tongue. If clicks are not heard, repeat cleaning procedure.
- TOWEL DRY
- **DO NOT:**
 - * Lubricate
 - * Use solvents
 - * Use abrasive cleaners
 - * Use soap or household detergents

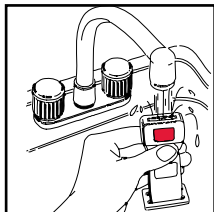



Replace the Buckle

NOTE: If removed, pull the belly pad over the metal retainer to replace prior to step 1.



1 Turn the buckle strap retainer so that the short side will go through the desired slots in the cover, foam and infant carrier shell.

2 Thread the buckle strap retainer through the desired slots in the infant carrier shell and cover to the bottom of the infant carrier shell.



3 Slide the buckle strap retainer into the tabs so it lies flat against the infant carrier shell.

4 Check that the buckle strap is not twisted and that the red release button faces out.



Troubleshooting the LATCH Connectors

If a click is not heard when connecting a LATCH connector:

- *Check that the LATCH connector strap is not too tight or twisted.*
- *Clean away any debris that may be in the LATCH connector.*

Troubleshooting the Head Restraint

If the head restraint is difficult to adjust or the head restraint does not move when releasing the adjuster handle:

- *The head restraint may be at maximum or minimum height.*
 - *The child's weight may be pressing against the head restraint or*
 - *The harness may need to be loosened.*
- * **Do not force the head restraint in either direction.**

Troubleshooting the Harness Adjuster

If the harness adjuster is hard to pull:

- *Pull the harness adjuster strap away from the child seat (parallel to the ground) to tighten.*
- * **Do not pull sideways.**
- * **Do not wrap the harness adjuster strap around your hand while pulling.**- *Check that the harness yoke is not tangled under the infant carrier. Always ensure the attachment points of the base are accessible or clear the seating area where the infant carrier will be installed of any objects or debris to ensure the infant carrier will perform as intended.*

If the adjuster strap is fraying at the sides:

- *Pull the harness adjuster strap away from the child seat (parallel to the ground) to tighten.*
- * **Do not pull sideways. Doing so can cause the harness adjuster strap to fray at the sides. See page 56.**

Please contact Consumer Services at 1.888.427.4829 if you have an issue not listed here.



This child restraint was manufactured by Britax Child Safety, Inc. ("Britax") warrants this product to the original retail purchaser as follows:

LIMITED ONE-YEAR WARRANTY

This product is warranted against defective materials or workmanship for one year from the date of original purchase. Proof of purchase is required. The exclusive remedy for this warranty is that Britax will, at its option, provide repair or replacement components for this product. Britax reserves the right to discontinue or change fabrics, parts, models or products, or to make substitutions.

To make a claim under this warranty, contact Britax Consumer Services at 1-888-427-4829 or write to us using the address on the back cover of this booklet. Proof of purchase is required.

COMPLETE AND MAIL THE OWNER REGISTRATION CARD WITHIN (30) DAYS OF PURCHASE. YOU MAY ALSO REGISTER ONLINE AT www.BritaxUSA.com/registration.

WARRANTY LIMITATIONS

This warranty does not include damages which arise from negligence, misuse or use not in accordance with the product instruction.

The use of aftermarket covers, inserts, toys, accessories, or tightening devices is not approved by Britax. Their use could cause this infant carrier to fail Federal Safety Standards or not perform as intended in a crash. Their use automatically voids the Britax warranty.

LIMITATION OF DAMAGES

The warranty and remedies as set forth above are exclusive and in lieu of all others, oral or written, express or implied. In no event will Britax, or the retailer selling this product, be liable for any damages, including incidental or consequential damages, arising out of the use or inability to use this product.

LIMITATIONS OF WARRANTIES AND OTHER WARRANTY TERMS AND STATE LAWS

Any implied warranties, including implied warranties of merchantability and fitness for a particular purpose, shall be limited to the duration and terms of the express written warranty. Some states do not allow limitations on how long an implied warranty lasts or the exclusion or limitation of incidental or consequential damages, so the above limitations may not apply. This warranty gives you specific legal rights, and you may have other rights, which vary from state to state. Neither Britax, nor the retailer selling this product, authorizes any person to create for it any other warranty, obligation, or liability in connection with this product.

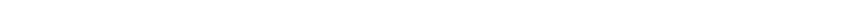



IMPORTANT:

- DOUBLE CHECK EVERY TIME YOU USE THIS CAR SEAT.**
-

Double Check Car Seat-to-Vehicle Installation:

- Check that the LATCH or vehicle seat belt connections to the vehicle are tight and secure.
- Verify the car seat cannot be moved front-to-back or side-to-side more than one inch (2.5 cm) at the belt path.

Double Check Child-to-Car Seat Installation:

- Tug on the buckle to ensure a proper connection.
- Confirm that the harness straps are snug and over both shoulders and hips. You should not be able to pinch excess harness strap webbing at the child's shoulder.
- Make sure the chest clip is properly fastened and positioned in the middle of the child's chest at armpit level.

Britax Child Safety, Inc.
13501 South Ridge Drive
Charlotte, NC 28273
USA

A **Britax Childcare Group**
Limited company

Tel. : 1-888-427-4829

www.Britax.com